

SER-
VING

TROLL-
EYS

I

EVINOKS



DOĞAYI ÖNEMİYOR VE
SÜRDÜRÜLEBİLİRLİĞİN DEVAMI İÇİN ÇALIŞIYORUZ.

WE CARE ABOUT THE NATURE AND WILL KEEP ON
PRODUCING FULLY ON A SUSTAINABLE BASIS.

photo courtesy of Ahmet Gülen

**EVINOXS**



İÇİNDEKİLER CONTENTS

SERVİS ARABALARI - I SERVING TROLLEYS - I

- 09** RESTAURANT SERVİS ARABALARI
RESTAURANT SERVING TROLLEYS
GOLD SERİSİ / GOLD SERIES
SILVER SERİSİ / SILVER SERIES
- 57** MUTFAK ARABALARI
KITCHEN TROLLEYS
GN TEPŞİ TAŞIMA ARABALARI / GN CONTAINER TROLLEYS
SERVİS TEPŞİSİ TAŞIMA ARABALARI / SERVICE TRAY TRANSPORT TROLLEYS
PATİSERİ ARABALAR / PATISSERIE TROLLEYS
ORDÖVR ARABALARI / HORS D'OEUVRE TROLLEYS
PASLANMAZ ÇELİK SERVİS ARABALARI / STAINLESS STEEL SERVICE TROLLEYS
TABAK TAŞIMA ARABALARI / DISH STORAGE TROLLEY
BASKET TAŞIMA ARABALARI / BASKET TRANSPORT TROLLEY
- 75** GARSON BANKOLARI
WAITER STATIONS
- 76** CARVING ÜNİTELERİ VE ASKILI SICAK TUTUCU LAMBALAR
CARVING UNITS
CARVING ÜNİTELERİ / CARVING UNITS
ASKILI SICAK TUTUCU LAMBALAR / HEAT LAMPS
- 80** MOBİL BAR VE RESEPSİYON MASASI
MOBILE BARS AND RECEPTION DESKS
MOBİL BAR / MOBILE BAR
MOBİL RESEPSİYON MASASI / MOBILE RECEPTION DESKS



**YENİLİKÇİ
VE ÇEVREÇİ**

**INNOVATIVE AND
GREEN**

EVİNOKS

Sektöründe öncü ve artan bir ivme ile her yıl büyüyen EVİNOKS; yaşayan showroom, idari bina ve üretim alanı ile birlikte toplamda 16.000 m2 kapalı alanda su, ısı ve enerji tasarrufu sağlayarak tamamen çevreci ve yenilikçi bir tesise sahiptir. Çevreci, geri dönüşümlü yapı elemanları kullanılarak yeşil bina statüsüne uygun bir bina inşa edilmiştir. EVİNOKS fabrikası, yeşil bina sertifikasını (LEED Gold) almaya aday gösterilebilecek niteliktedir. Bünyesinde bulunan birçok patentli ürünüyle ve sahip olduğu uluslararası sertifikalarla (CE-SASO-ISO 9001) Amerika, Avrupa, Kuzey ve Orta Afrika, Orta Asya, Orta Doğu gibi pek çok bölgeye ihracat yapan bir firmadır. Rixos, Sheraton, Hilton, Dedeman, Ramada, Crown Plaza, Marriott, Radisson, Mövenpick, Holiday Inn, Divan, Magic Life gibi uluslararası otellerin projelerinde yer almaya devam etmektedir. Yaratıcı ve mükemmelin peşinde bir ekip ruhuyla koşan EVİNOKS, her yeni ürününde fark yaratmayı ve başarısının sürekliliğini sağlamayı hedeflemiştir. Teknolojiye gelince; Evinoks ahşap ve metal işçiliğinden gurur duymakta olup modern makineleri ile üretimini güçlendirmiş ve kısa zaman öncede CNC kontrollü metal ve ahşap işleme makineleri ile robot kaynak teknolojilerini üretim parkına katmıştır.

Having a 16.000 m2 indoor area with a live showroom, production, offices, the factory creates an environmental and innovative working atmosphere both for the community and the employees as well as saving energy, water and heat. The facility was built up completely with recycled materials according to Green Building Standards. EVİNOKS facility is capable of being a candidate to the LEEDS Gold Green Building status. Evinoks has international (CE-SASO-ISO 9001) certification and is the supplier of international and national chains like Sheraton, Hilton, Dedeman, Ramada, Crown Plaza, Marriott, Radisson, Rixos, Mövenpick, Holiday Inn, Rotana, Divan etc. In search of innovation and excellence with team spirit, EVİNOKS makes a difference in every product produced. "As regard of the technology ; Evinoks is proud of its metal and wooden craftsmanship as well as the modernised machinery park recently renovated with the CNC controlled metal & wood processing machines, and robot welding.



RESTAURANT SERVİS ARABALARI

RESTAURANT SERVING TROLLEYS



GOLD SERİSİ SERVİS ARABALARI

Kaliteli servis arabaları servis sunumlarınızı bir şölene çevirir. Doğal kaplama raflar, yan yüzeyler ve masif ayaklar ürüne estetik bir görünüm sunar. AISI 304 paslanmaz çelik metal aksesuarlar da şık yapıyı tamamlar.

High quality serving trolleys changes your serving presentation into a feast. Wood veneer on shelf and sides and solid wood legs give an aesthetics look. AISI 304 stainless steel metal accessories complete the chic construction.

PATENTED / PATENTLİ

Uyarı: Direkt güneş altında, yağmur ve deniz rüzgarına karşı kullanım önerilmez.
Warning: Not recommended for usage under direct sunlight, rain or sea wind.

GOLD SERİSİ

SERVİS ARABALARI

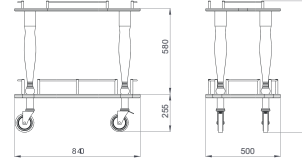

GLSA 102

Dış Ölçüler: 840x500x835/885 mm
Kenarlıklar AISI 304 s/s mil
Ağırlık: 28 kg
Dimensions: 840x500x835/885 mm
AISI 304 s/s protective rails
Weight: 28 kg

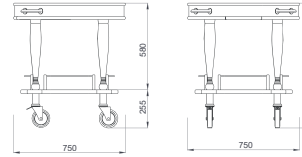

GLSA 112

Dış Ölçüler: Ø 750x 835 mm
İtme kulbu ve kenarlıklar AISI 304 s/s
Sürgülü tabla
Ağırlık: 30 kg
Dimensions: Ø 750x 835 mm
AISI 304 s/s protective rails and
handle for pushing
Extractable serving table
Weight: 30 kg



GOLD SERIES

SERVING TROLLEYS

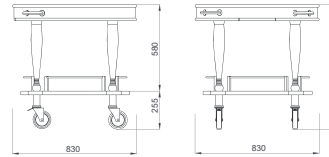

GLSA 122

Dış Ölçüler : Ø 830x835 mm
İtme kulbu ve kenarlıklar AISI 304 s/s
Sürgülü tabla
Ağırlık:32 kg
Dimensions: Ø 830x835 mm
AISI 304 s/s protective rails and
handle for pushing
Extractable serving table
Weight: 32 kg

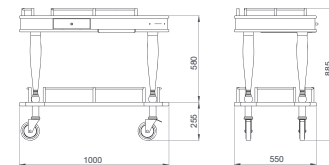

GLSA 132

Dış Ölçüler :1000x550x835/885 mm
İtme kulbu ve kenarlıklar AISI 304 s/s
Sürgülü tabla
Ağırlık :57 kg
Dimensions: 1000x550x835/885 mm
AISI 304 s/s protective rails and
handle for pushing
Extractable serving table
Weight: 57 kg



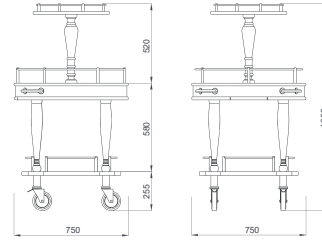

GLSA 142

Dış Ölçüler : Ø 750x835/1350 mm
İtme kulbu ve kenarlıklar AISI 304 s/s
Sürgülü tabla
Ø 500 mm ahşap tablalı bardak standı
Ağırlık : 34 kg

Dimensions: Ø 750x835/1350 mm
AISI 304 s/s protective rails and handle for pushing
Extractable serving table
Wooden stand for glasses with wooden leg on upper shelf 500 mm
Weight : 34 kg



GOLD SERIES SERVING TROLLEYS

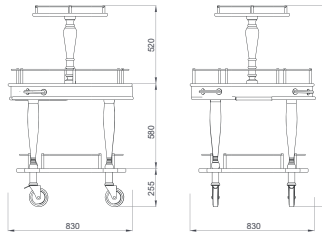

GLSA 152

Dış Ölçüler : Ø 830x835/1355 mm
İtme kulbu ve kenarlıklar AISI 304 s/s
Sürgülü tabla
Ø 500 mm ahşap tablalı bardak standı
Ağırlık : 38 kg

Dimensions: Ø 830x835/1355 mm
AISI 304 s/s protective rails and handle for pushing
Extractable serving table
Wooden stand for glasses with wooden leg on upper shelf 500 mm
Weight : 38 kg



GOLD SERİSİ

ŞARAP SERVİS ARABALARI

GLST 112

Dış Ölçüler :1000x550x 835/ 935 mm
Üst tabla komple AISI 304 s/s sac
Sürgülü tabla
İtme kulbu ve kenarlıklar AISI 304 s/s
Alt tablada seyyar şişelik
4 adet akrilik şişe soğutucu
Şarap kovası ve buz kovası opsiyoneldir
Ağırlık:55 kg

Dimensions: 1000x550x 835/ 935 mm
Upper work surface with AISI 304 s/s
Extractable serving table
AISI 304 s/s protective rails and handle for pushing
Mobile bottle holder on lower shelf
4 pcs of acrylic wine coolers
Wine buckets and ice buckets are optional
Weight: 55 kg

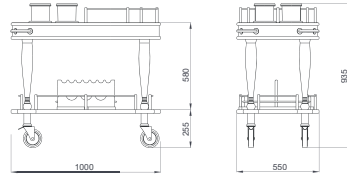

GLST 122

Dış Ölçüler :1000x550x 835 / 935 mm
Üst tabla komple AISI 304 s/s sac
Sürgülü tabla
İtme kulbu ve kenarlıklar AISI 304 s/s
Alt tablada seyyar şişelik
Şarap kovası ve buz kovası opsiyoneldir
Ağırlık:55 kg

Dimensions: 1000x550x 835 / 935 mm
Upper work surface with AISI 304 s/s
Extractable serving table
AISI 304 s/s protective rails and handle for pushing
Mobile bottle holder on lower shelf
Wine buckets and ice buckets are optional
Weight: 55 kg



GLST 132

Dış Ölçüler :1000x550x835 /1355 mm
Üst tabla komple AISI 304 s/s sac
Sürgülü tabla
İtme kulbu ve şişe tutucu AISI 304 s/s
Ø 500 mm ahşap tablalı bardak standı
Pleksli glass bardaklık
Alt tablada seyyar şişelik
4 adet akrilik şişe soğutucu
Şarap kovası ve buz kovası opsiyoneldir
Ağırlık:61 kg

Dimensions: 1000x550x835 /1355 mm
Upper work surface with AISI 304 s/s
Extractable serving table
AISI 304 s/s bottle holder and handle for pushing
Wooden stand for glasses with wooden leg on upper shelf 500 mm
Plexiglass stand with catches for holding glasses
Mobile bottles holder on lower shelf
4 pcs of acrylic wine coolers
Wine buckets and ice buckets are optional
Weight: 61 kg

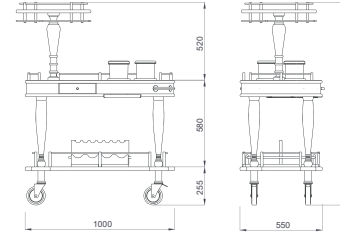

GOLD SERIES

WINE DISPLAY TROLLEYS

GLST 142

Dış Ölçüler :1000x550x835 /1355 mm
Üst tabla komple AISI 304 s/s sac
Sürgülü tabla
İtme kulbu ve şişe tutucu AISI 304 s/s
Ø 500 mm ahşap tablalı bardak standı
Pleksli glass bardaklık
Alt tablada seyyar şişelik
Şarap kovası ve buz kovası opsiyoneldir
Ağırlık:61 kg

Dimensions: 1000x550x835 /1355 mm
Upper work surface with AISI 304 s/s
Extractable serving table
AISI 304 s/s bottle holder and handle for pushing
Wooden stand for glasses with wooden leg on upper shelf 500 mm
Plexiglass stand with catches for holding glasses
Mobile bottles holder on lower shelf
Wine buckets and ice buckets are optional
Weight: 61 kg

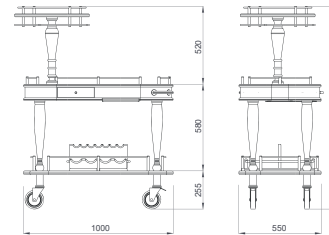

GOLD SERİSİ

LİKÖR VE ŞARAP SERVİS ARABALARI



GLIS 102

- Dış Ölçüler :840x500x835/1355 mm
- 400 mm ahşap tabanlı bardak standı
- Plexi glass bardaklık
- Bir adet çekmece
- Sürgülü tabla
- Kenarlıklar ve itme kulbu AISI 304 s/s
- Şarap kovası ve buz kovası opsiyoneldir
- Ağırlık :35 kg

- Dimensions: 840x500x835/1355 mm
- Wooden stand for glasses with wooden leg on upper shelf 400 mm
- Plexiglass stand with catches for holding glasses
- Drawer and extractable serving table
- AISI 304 s/s protective rails and handle for pushing
- Wine buckets and ice buckets are optional
- Weight: 35 kg

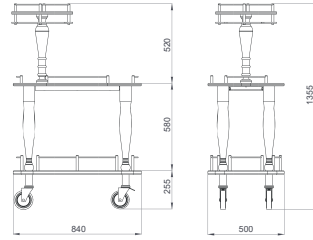

GLIS 122

- Dış Ölçüler : Ø 830x835/1355 mm
- 500 mm ahşap tabanlı bardak standı
- Plexi glass bardaklık
- Sürgülü tabla
- İtme kulbu ve kenarlıklar AISI 304 s/s
- Şarap kovası ve buz kovası opsiyoneldir
- Ağırlık :48 kg

- Dimensions: Ø 830x835/1355 mm
- Wooden stand for glasses with wooden leg on upper shelf 500 mm
- Plexiglass stand with catches for holding glasses
- Extractable serving table
- AISI 304 s/s protective rails and handle for pushing
- Wine buckets and ice buckets are optional
- Weight: 48 kg

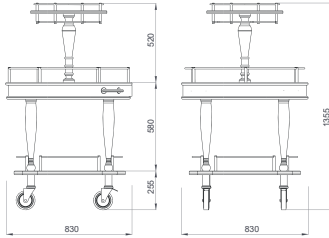

GLIS 142

- Dış Ölçüler : Ø 830x835/1355 mm
- Ø500 mm ahşap tabanlı bardak standı
- Sürgülü tabla
- İtme kulbu ve kenarlıklar AISI 304 s/s
- Şarap kovası ve buz kovası opsiyoneldir
- Ağırlık :48 kg

- Dimensions: Ø 830x835/1355 mm
- Wooden stand for glasses with wooden leg on upper shelf 500 mm
- Extractable serving table
- AISI 304 s/s protective rails and handle for pushing
- Wine buckets and ice buckets are optional
- Weight: 48 kg

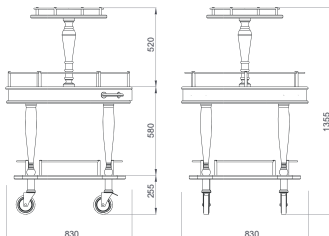

GOLD SERIES

LIQUOR AND WINE SERVING TROLLEYS



GLIS 312

- Dış Ölçüler :1000x550x835/1050 mm
- Alt tabla üzerinde seyyar şişelik
- Üst tabla altında plexi glass bardak tutucu
- Bir adet çekmece ve sürgülü tabla
- İtme kulbu ve kenarlıklar AISI 304 s/s
- 2 adet izoleli buz kovası
- Şarap kovası ve buz kovası opsiyoneldir
- Ağırlık :52 kg

- Dimensions: 1000x550x835/1050 mm
- Mobile bottle stand on lower shelf
- Plexiglass stand with catches for holding glasses under upper shelf
- Drawer and extractable serving table
- AISI 304 s/s protective rails and handle for pushing
- 2 pcs of isolated ice buckets
- Wine buckets and ice buckets are optional
- Weight: 52 kg

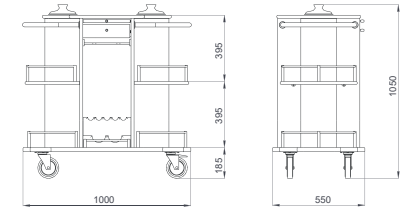

GOLD SERİSİ

PEYNİR VE TATLI ARABALARI



GLCS 102

- Dış Ölçüler: Ø 750x835/1110 mm
- Buz akülü soğutma sistemi
- ABS buz aküsü havuzu Ø 440 / 65 mm
- Soğutma yüzeyi perfore AISI 304 s/s sac Ø 520 mm
- 180 dönebilir plexi glass camekan
- Sürgülü tabla
- İtme kulbu ve kenarlıklar AISI 304 s/s
- Ağırlık :41 kg

- Dimensions: Ø 750x835/1110 mm
- Cooling system with eutectic cooling pack
- ABS cooling well with eutectic cooling pack Ø 440 / 65 mm
- Perforated AISI 304 s/s cooling surface Ø 520 mm
- Plexiglass roll top adjustable to 180 degrees
- Extractable serving table
- AISI 304 s/s tube handle for pushing and protective rails
- Weight: 41 kg



GLCS 112

- Dış Ölçüler: Ø 750x835 /1110 mm
- Pleksi glass fanus içinde seyir corian servis tablası Ø 520 mm
- 180 dönebilir plexi glass camekan
- Sürgülü tabla
- İtme kulbu ve kenarlıklar AISI 304 s/s
- Ağırlık: 43 kg

- Dimensions: Ø 750x835 /1110 mm
- Mobile corian serving surface inside plexi glass roll top Ø 520 mm
- Plexiglass roll top adjustable to 180 degrees
- Extractable serving table
- AISI 304 s/s tube handle for pushing and protective rails
- Weight: 43 kg

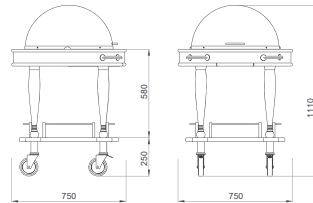

GOLD SERIES

CHEESE AND DESSERT TROLLEYS

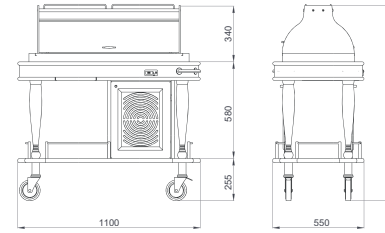

GLCS 302 (+4/+10C)

- Dış Ölçüler: 1100x550x835 /1175 mm
- Kompresörlü soğutma sistemi (R404A-250W-230v 1N AC 50 Hz)
- Soğutma yüzeyi perfore AISI 304 s/s sac
- Havuz Ölçüsü :800x340x85 mm
- İki taraftan sürgülü açılabilen plexi glass camekan
- Aşap servis rafı
- Sürgülü tabla
- İtme kulbu ve kenarlıklar AISI 304 s/s
- Dijital göstergeli termostat
- Ağırlık :91 kg

- Dimensions: 1100x550x835 /1175 mm
- Cooling system with compressor (R 404A -500w-230v 1N AC -50 Hz)
- Perforated AISI 304 s/s cooling surface
- Well dimensions: 800x340x85 mm
- Plexiglass roll top with lids opening from both sides
- Wooden serving shelf on plexiglass top
- Extractable serving table
- AISI 304 s/s tube handle for pushing and protective rails
- Thermostat with digital indicator
- Weight: 91 kg

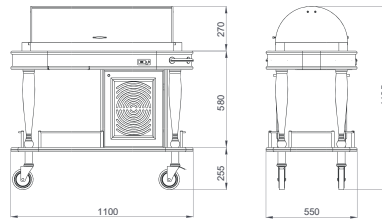

GLCS 312 (+4/+10C)

- Dış Ölçüler: 1100x550x835 /1105 mm
- Kompresörlü soğutma sistemi (R404A-250W-230v 1N AC 50 Hz)
- Soğutma yüzeyi perfore AISI 304 s/s sac
- Havuz Ölçüsü : 800x340x85 mm
- İki taraftan sürgülü açılabilen plexi glass camekan
- Sürgülü tabla
- İtme kulbu ve kenarlıklar AISI 304 s/s
- Dijital göstergeli termostat
- Ağırlık :89 kg

- Dimensions: 1100x550x835 /1105 mm
- Cooling system with compressor (R 404A -500w-230v 1N AC -50 Hz)
- Perforated AISI 304 s/s cooling surface
- Well dimensions: 800x340x85 mm
- Plexiglass roll top with lids opening from both sides
- Extractable serving table
- AISI 304 s/s tube handle for pushing and protective rails
- Thermostat with digital indicator
- Weight: 89 kg



GOLD SERİSİ

PASTA ARABALARI

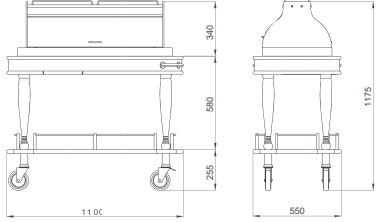

GLPS 102

- Dış Ölçüler :1100x550x835/1175 mm
- Buz akülü soğutma sistemi
- Perfore AISI 304 s/s soğutma yüzeyi
- Havuz Ölçüsü: 800x340x85 mm
- İki taraftan sürgülü açılabilir plexi glass camekan
- Ahşap servis rafı
- Sürgülü tabla
- İtme kulbu ve kenarlıklar AISI 304 s/s
- Ağırlık :64 kg

- Dimensions: 1100x550x835/1175 mm
- Cooling system with eutectic cooling pack
- Perforated AISI 304 s/s cooling surface
- Well dimensions: 800x340x85 mm
- Plexiglass roll top with lids opening from both sides
- Wooden serving shelf on plexiglass top
- Extractable serving table
- AISI 304 s/s protective rails and handle for pushing
- Weight: 64 kg

GOLD SERIES

PASTRY TROLLEYS

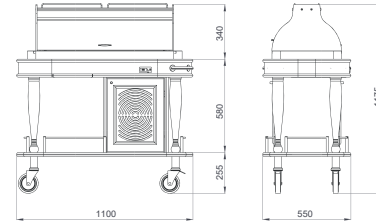

GLPS 302 (+4/+10C)

- Dış Ölçüler :1100x550x835/1175 mm
- Kompresörlü soğutma sistemi(R404A-250W-230v 1N AC 50 Hz)
- Perfore AISI 304 s/s soğutma yüzeyi
- Havuz Ölçüsü :800x340x85 mm
- İki taraftan sürgülü açılabilir plexi glass camekan
- Ahşap servis rafı
- Sürgülü tabla
- İtme kulbu ve kenarlıklar AISI 304 s/s
- Dijital göstergeli termostat
- Ağırlık :91 kg

- Dimensions: 1100x550x835/1175 mm
- Cooling system with compressor (R404A-250W-230v 1N AC 50 Hz)
- Perforated AISI 304 s/s cooling surface
- Well dimensions: 800x340x85 mm
- Plexiglass roll top with lids opening from both sides
- Wooden serving shelf on plexiglass top
- Extractable serving table
- AISI 304 s/s protective rails and handle for pushing
- Thermostat with digital indicator
- Weight: 91 kg

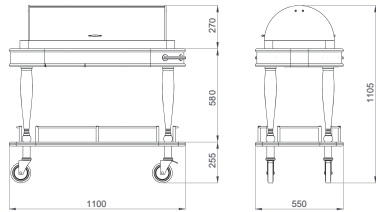

GLPS 112

- Dış Ölçüler:1100x550x835/1105 mm
- Buz akülü soğutma sistemi
- Perfore AISI 304 s/s soğutma yüzeyi
- Havuz Ölçüsü :800x340x85 mm
- İki taraftan açılabilir plexi glass camekan
- Sürgülü tabla
- İtme kulbu ve kenarlıklar AISI 304 s/s
- Ağırlık :63 kg

- Dimensions: 1100x550x835/1105 mm
- Cooling system with eutectic cooling pack
- Perforated AISI 304 s/s cooling surface
- Well dimensions: 800x340x85 mm
- Plexiglass roll top with lids opening from both sides
- Extractable serving table
- AISI 304 s/s protective rails and handle for pushing
- Weight: 63 kg

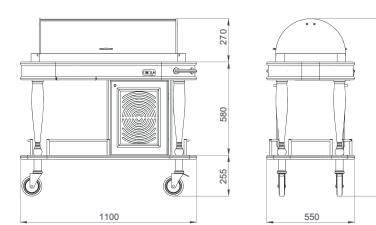

GLPS 312 (+4/+10C)

- Dış Ölçüler :1100x550x835/1105 mm
- Kompresörlü soğutma sistemi (R404A-250W-230v 1N AC 50 Hz)
- Perfore AISI 304 s/s soğutma yüzeyi
- Havuz Ölçüsü :800x340x85 mm
- İki taraftan sürgülü açılabilir plexi glass camekan
- Ahşap servis rafı,sürgülü tabla
- İtme kulbu ve kenarlıklar AISI 304 s/s
- Dijital göstergeli termostat
- Ağırlık :89 kg

- Dimensions: 1100x550x835/1105 mm
- Cooling system with compressor (R404A-250W-230v 1N AC 50 Hz)
- Perforated AISI 304 s/s cooling surface
- Well dimensions: 800x340x85 mm
- Plexiglass roll top with lids opening from both sides
- Extractable serving table
- AISI 304 s/s protective rails and handle for pushing
- Thermostat with digital indicator
- Weight: 89 kg

GOLD SERİSİ

MEZE ARABALARI

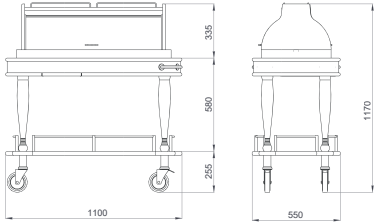

GLMS 102

- Dış Ölçüler : 1100x550x835/1170 mm
- Buz akülü soğutma sistemi
- 4 x GN 1/3 + 2 x GN 1/6 kapasiteli
- Havuz Ölçüsü :800x340x85 mm
- İki taraftan sürgülü açılabilen plexi glass camekan
- Ahşap servis rafı
- Sürgülü tabla
- İtme kulbu ve kenarlıklar AISI 304 s/s
- Ağırlık :65 kg

- Dimensions: 1100x550x835/1170 mm
- Cooling system with eutectic cooling pack
- 4 X GN 1/3 + 2 X GN 1/6 capacity
- Well dimensions: 800x340x85 mm
- Plexiglass roll top with lids opening from both sides
- Wooden serving shelf on plexiglass top
- Extractable serving table
- AISI 304 s/s protective rails and handle for pushing
- Weight: 65 kg



GOLD SERIES

APPETIZER TROLLEYS

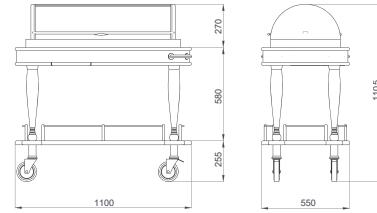

GLMS 112

- Dış Ölçüler :1100x550x835/1105 mm
- Buz akülü soğutma sistemi
- Havuz Ölçüsü : 800x340x85 mm
- İki taraftan sürgülü açılabilen ,yanları ahşap kaplı plexi glass camekan
- Sürgülü tabla
- İtme kulbu ve kenarlıklar AISI 304 s/s
- 4 x GN 1/3 + 2 x GN 1/6 kapasiteli
- Ağırlık :90 kg

- Dimensions: 1100x550x835/1105 mm
- Cooling system with eutectic cooling pack
- Well dimensions: 800x340x85 mm
- Plexiglass roll top with lids opening from both sides
- Extractable serving table
- AISI 304 s/s protective rails and handle for pushing
- 4 x GN 1/3 + 2 x GN 1/6 capacity
- Weight: 90 kg

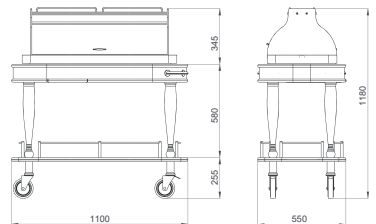

GLMS 103

- Dış Ölçüler : 1100x550x835/1180 mm
- Buz akülü soğutma sistemi
- 4 x GN 1/3 + 2 x GN 1/6 kapasiteli
- Havuz Ölçüsü :800x340x85 mm
- İki taraftan sürgülü açılabilen plexi glass camekan
- Ahşap servis rafı
- Sürgülü tabla
- İtme kulbu ve kenarlıklar AISI 304 s/s
- Ağırlık :65 kg

- Dimensions: 1100x550x835/1180 mm
- Cooling system with eutectic cooling pack
- 4 x GN 1/3 + 2 x GN 1/6 capacity
- Well dimensions: 800x340x85 mm
- Plexi glass roll top with lids opening from both sides
- Wooden serving shelf on plexiglass top
- Extractable serving table
- AISI 304 s/s protective rails and handle for pushing
- Weight: 65 kg

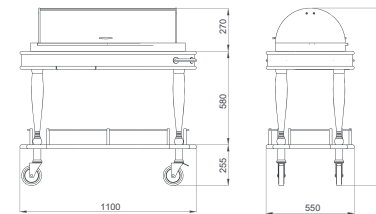

GLMS 113

- Dış Ölçüler :1100x550x835/1105 mm
- Buz akülü soğutma sistemi
- Havuz Ölçüsü : 800x340x85 mm
- İki taraftan sürgülü açılabilen ,plexi glass camekan
- Sürgülü tabla
- İtme kulbu ve kenarlıklar AISI 304 s/s
- 4 x GN 1/3 + 2 x GN 1/6 kapasiteli
- Ağırlık :90 kg

- Dimensions: 1100x550x835/1105 mm
- Cooling system with eutectic cooling pack
- Well dimensions: 800x340x85 mm
- Plexiglass roll top with lids opening from both sides
- Extractable serving table
- AISI 304 s/s protective rails and handle for pushing
- 4 x GN 1/3 + 2 x GN 1/6 capacity
- Weight: 90 kg



GOLD SERİSİ

MEZE ARABALARI

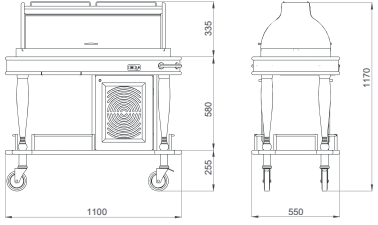

GLMS 302 (+4/+10C)

- Dış Ölçüler :1100x550x835/1170 mm
- Kompresörlü soğutma sistemi (R404A-250W-230v 1N AC 50 Hz)
- 4 x GN 1/3 + 2 x GN 1/6 kapasiteli
- Havuz Ölçüsü : 800x340x85 mm
- İki taraftan sürgülü açılabilen ,yanları ahşap kaplı plexi glass camekan
- Ahşap servis rafı
- Sürgülü tabla
- İtme kulbu ve kenarlıklar A ISI 304 s/s
- Dijital göstergeli termostat
- Ağırlık :92 kg

- Dimensions: 1100x550x835/1170 mm
- Cooling system with compressor (R404A-250W-230v 1N AC 50 Hz)
- 4 X GN 1/3 + 2 X GN 1/6 capacity
- Well dimensions: 800x340x85 mm
- Plexiglass roll top with lids opening from both sides
- Wooden serving shelf on plexiglass top
- Extractable serving table
- AISI 304 s/s protective rails and handle for pushing
- Thermostat with digital indicator
- Weight: 92 kg

GOLD SERIES

APPETIZER TROLLEYS

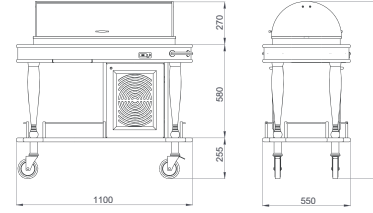

GLMS 313 (+4/+10C)

- Dış Ölçüler : 1100x550x835/1105 mm
- Kompresörlü soğutma sistemi (R404A-250W-230v 1N AC 50 Hz)
- 4 x GN 1/3 + 2 x GN 1/6 kapasiteli
- Havuz Ölçüsü : 800x340x85 mm
- İki taraftan sürgülü açılabilen ,yanları ahşap kaplı plexi glass camekan
- Sürgülü tabla
- İtme kulbu ve kenarlıklar AISI 304 s/s
- Dijital göstergeli termostat
- Ağırlık :64 kg

- Dimensions: 1100x550x835/1105 mm
- Cooling system with compressor (R404A-250W-230v 1N AC 50 Hz)
- 4 x GN 1/3 + 2 x GN 1/6 capacity
- Well dimensions: 800x340x85 mm
- Plexiglass roll top with lids opening from both sides
- Extractable serving table
- AISI 304 s/s protective rails and handle for pushing
- Thermostat with digital indicator
- Weight: 64 kg

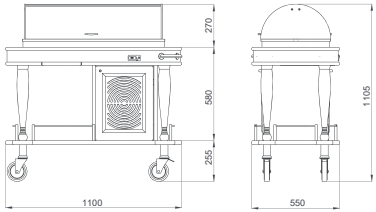

GLMS 312 (+4/+10C)

- Dış Ölçüler : 1100x550x835/1105 mm
- Kompresörlü soğutma sistemi (R404A-250W-230v 1N AC 50 Hz)
- 4 x GN 1/3 + 2 x GN 1/6 kapasiteli
- Havuz Ölçüsü : 800x340x85 mm
- İki taraftan sürgülü açılabilen ,yanları ahşap kaplı plexi glass camekan
- Sürgülü tabla
- İtme kulbu ve kenarlıklar AISI 304 s/s
- Dijital göstergeli termostat
- Ağırlık :64 kg

- Dimensions: 1100x550x835/1105 mm
- Cooling system with compressor (R404A-250W-230v 1N AC 50 Hz)
- 4 x GN 1/3 + 2 x GN 1/6 capacity
- Well dimensions: 800x340x85 mm
- Plexiglass roll top with lids opening from both sides
- Extractable serving table
- AISI 304 s/s protective rails and handle for pushing
- Thermostat with digital indicator
- Weight: 64 kg



GOLD SERİSİ

SICAK MEZE ARABALARI

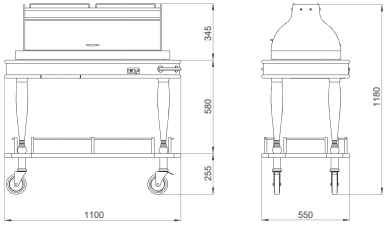

GLSS 102 (+30/+110C)

- Dış Ölçüler :1100x550x835/1180 mm
- Kuru tip rezistanslı ısıtmalı
- 4x1/3 /6,5 cm GN + 2x1/6 x 6,5cm GN kapasiteli
- Havuz Ölçüsü :800x340x85 mm
- İki taraftan sürgülü açılabilir,plexi glass camekan
- Ahşap servis raflı
- Sürgülü tabla
- İtme kulbu ve kenarlıklar AISI 304 s/s
- Tabak servisi için AISI 304 s/s katlanabilir tabaklık
- Dijital göstergeli termostat
- Ağırlık:65 kg

- Dimensions: 1100x550x835/1180 mm
- Dry heating system with resistance
- 4x1/3 /6,5 cm GN + 2x1/6 x 6,5cm GN capacity
- Well dimensions: 800x340x85 mm
- Plexiglass roll top with lids opening from both sides
- Wooden serving shelf on plexiglass top
- Extractable serving table
- AISI 304 s/s protective rails and handle for pushing
- AISI 304 s/s foldable dish plate
- Thermostat with digital indicator
- Weight: 65 kg



GOLD SERIES

HOT APPETIZER TROLLEYS

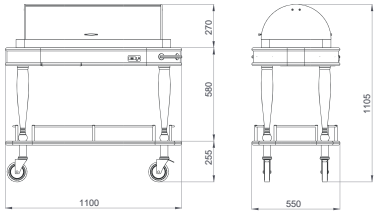

GLSS 112 (+30/110C)

- Dış Ölçüler :1100x550x835/1105 mm
- Kuru tip rezistanslı ısıtmalı
- 4x1/3 /6,5 cm GN + 2x1/6 x 6,5cm GN kapasiteli
- Havuz Ölçüsü :800x340x85 mm
- İki taraftan sürgülü açılabilir,plexi glass camekan
- Sürgülü tabla
- İtme kulbu ve kenarlıklar AISI 304 s/s
- Tabak servisi için AISI 304 s/s katlanabilir tabaklık
- Dijital göstergeli termostat
- Ağırlık:65 kg

- Dimensions: 1100x550x835/1105 mm
- Dry heating system with resistance
- 4x1/3 /6,5 cm GN + 2x1/6 x 6,5cm GN capacity
- Well dimensions: 800x340x85 mm
- Plexiglass roll top with lids opening from both sides
- Extractable serving table
- AISI 304 s/s protective rails and handle for pushing
- AISI 304 s/s foldable dish plate
- Thermostat with digital indicator
- Weight: 65 kg



GOLD SERİSİ

BALIK TEŞHİR ARABALARI

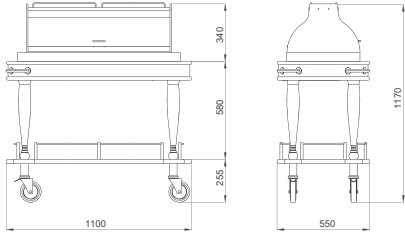

GLBT 102

- Dış Ölçüler: 1100x550x 835 /1170 mm
- Buz havuzlu soğutma sistemi
- Soğutma havuzu , izoleli AISI 304 s/s
- Havuz Ölçüsü :800x340x85 mm
- İki taraftan sürgülü açılabilir plexi glass camekan
- Ahşap servis rafı
- Sürgülü tabla
- İtme kulbu ve kenarlıklar AISI 304 s/s
- Ağırlık : 65 kg

- Dimensions: 1100x550x 835 /1170 mm
- Cooling system with eutectic cooling pack
- Insulated AISI 304 s/s cooling well
- Well dimensions: 800x340x85 mm
- Plexiglass roll top with lids opening from both sides
- Wooden serving shelf on plexiglass top
- Extractable serving table
- AISI 304 s/s tube handle for pushing and protective rails
- Weight: 65 kg

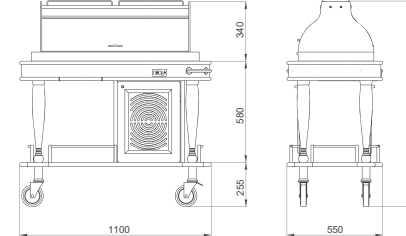

GLBT 302 (-2/0C)

- Dış Ölçüler: 1100x550x835 /1175 mm
- Kompresörlü soğutma sistemi(R404A-250W-230v 1N AC 50 Hz)
- Soğutma havuzu izoleli AISI 304 s/s
- Havuz Ölçüsü :800x340x85 mm
- İki taraftan sürgülü açılabilir plexi glass camekan
- Ahşap servis rafı
- Sürgülü tabla
- İtme kulbu ve kenarlıklar AISI 304 s/s
- Dijital göstegeli termostat
- Ağırlık :90 kg

- Dimensions: 1100x550x835 /1175 mm
- Cooling system with compressor (R 404A -500w-230v 1N AC -50 Hz)
- Insulated AISI 304 s/s cooling well
- Well dimensions: 800x340x85 mm
- Plexiglass roll top with lids opening from both sides
- Wooden serving shelf on plexiglass top
- Extractable serving table
- AISI 304 s/s tube handle for pushing and protective rails
- Thermostat with digital indicator
- Weight: 90 kg

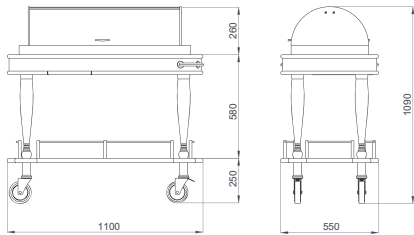

GLBT 112

- Dış Ölçüler: 1100x550x835 /1090 mm
- Buz havuzlu soğutma sistemi
- Soğutma havuzu izoleli AISI 304 s/s
- Havuz Ölçüsü :800x340x85 mm
- İki taraftan sürgülü açılabilir plexi glass camekan
- Sürgülü tabla
- İtme kulbu ve kenarlıklar AISI 304 s/s
- Ağırlık :63 kg

- Dimensions: 1100x550x835 /1090 mm
- Cooling system with eutectic cooling pack
- Insulated AISI 304 s/s cooling well
- Well dimensions: 800x340x85 mm
- Plexiglass roll top with lids opening from both sides
- Extractable serving table
- AISI 304 s/s tube handle for pushing and protective rails
- Weight: 63 kg



GOLD SERIES

FISH DISPLAY TROLLEYS

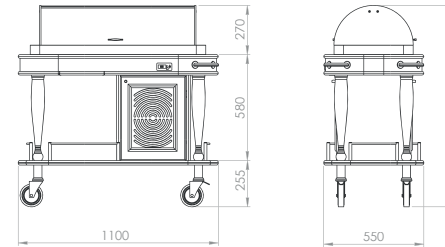

GLBT 312 (-2/0C)

- Dış Ölçüler: 1100x550x835 /1105 mm
- Kompresörlü soğutma sistemi (R404A-250W-230v 1N AC 50 Hz)
- Soğutma havuzu izoleli AISI 304 s/s sac
- Havuz Ölçüsü :800x340x85 mm
- İki taraftan sürgülü açılabilir plexi glass camekan
- Sürgülü tabla
- İtme kulbu ve kenarlıklar AISI 304 s/s
- Dijital göstegeli termostat
- Ağırlık :88 kg

- Dimensions: 1100x550x835 /1105 mm
- Cooling system with compressor (R 404A -500w-230v 1N AC -50 Hz)
- Insulated AISI 304 s/s cooling well
- Well dimensions: 800x340x85 mm
- Plexiglass roll top with lids opening from both sides
- Extractable serving table
- AISI 304 s/s tube handle for pushing and protective rails
- Thermostat with digital indicator
- Weight: 88 kg



GOLD SERİSİ

ROAST BEEF ARABALARI

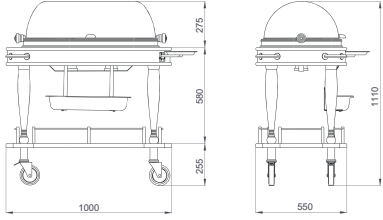

GLRB 102

- Dış Ölçüler :1000x550x835/1110 mm
- Elektrikli veya jel yakıtlı ısıtma sistemi (siparişte belirtilmeli)
- Bir adet polietilen kesme tablası
- Sürgülü tabla
- İtme kulbu ve kenarlıklar AISI 304 s/s
- A ISI 304 s/s servis çatal-bıçak kabı,katlanabilir tabaklık, 2 adet sosluk
- Dijital göstergeli termostat
- Ağırlık: 65 kg

- Dimensions: 1000x550x835/1110 mm
- Heating system with electricity or gel fuel (Must be specified when ordering)
- Polyethylene cutting board
- Extractable serving table
- AISI 304 s/s tube handle for pushing and protective rails
- AISI 304 s/s cutlery serving plate, foldable dish holder, 2 pcs of spice containers
- Thermostat with digital indicator
- Weight: 65 kg



GOLD SERİSİ

FLAMBE ARABALARI

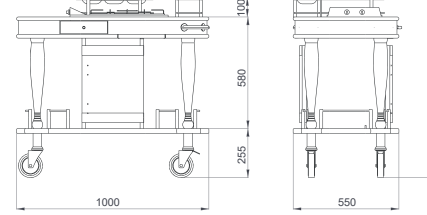

GLFA 102

- Dış Ölçüler: 1000x550x835 /935 mm
- Sıcak tavaların ahşaba zarar vermemesi için 3 sıra krom mil
- Bir adet çekmece ve sürgülü tabla
- Ocaklı paslanmaz çelik gövdeli, çakmaklı, gazlı ocak
- İtme kulbu ve kenarlıklar AISI 304 s/s
- AISI 304 s/s mil şişelik (Baharatlık opsiyonel)
- Tüp dolabı (Tüp hariç)
- Ağırlık :55 kg

- Dimensions: 1000x550x835 /935 mm
- 3 pcs of metal rods to prevent hot pans give damage to the wooden surface
- Drawer and extractable serving table
- Two-headed AISI 304 s/s burner with gas and lighting device
- AISI 304 s/s tube handle for pushing and protective rails
- AISI 304 s/s bottle holders(Spice containers are optional)
- Wooden cabinet for gas cylinder on lower shelf (without gas cylinder)
- Weight: 55 kg



GOLD SERIES

ROAST BEEF TROLLEYS

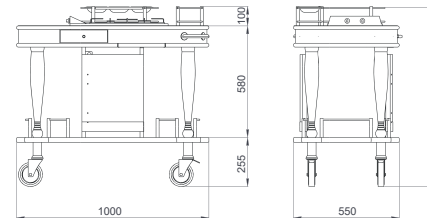

GLFP 102

- Dış Ölçüler :1000x550x835 /935 mm
- Üst tabla tamamen A ISI 304 s/s sac
- Bir adet çekmece ve sürgülü tabla
- 2 ocaklı paslanmaz çelik gövdeli, çakmaklı ,gazlı ocak
- İtme kulbu ve kenarlıklar AISI 304 s/s
- A ISI 304 s/s mil şişelik (Baharatlık opsiyonel)
- Tüp dolabı (Tüp hariç)
- Ağırlık :57 kg

- Dimensions: 1000x550x835 /935 mm
- Upper working surface with AISI 304 s/s
- Drawer and extractable serving table
- Two-headed AISI 304 s/s burner with gas and lighting device
- AISI 304 s/s tube handle for pushing and protective rails
- AISI 304 s/s bottle holders(Spice containers are optional)
- Wooden cabinet for gas cylinder on lower shelf (without gas cylinder)
- Weight: 57 kg



GOLD SERİSİ GUERİDON ARABALARI

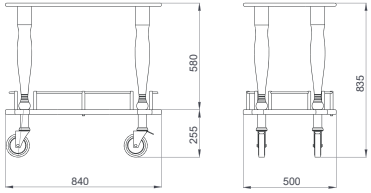

GLGR 102

- Dış Ölçüler: 840x500x835 mm
- Kenarlıklar AISI 304 s/s mil
- Ağırlık: 28 kg
- Dimensions: 840x500x835 mm
- AISI 304 s/s protective rails
- Weight: 28 kg

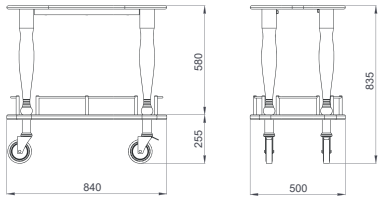

GLGR 112

- Dış Ölçüler: 840x500x835 mm
- Sürgülü tabla
- Kenarlıklar AISI 304 s/s mil
- Ağırlık: 29 kg
- Dimensions: 840x500x835 mm
- Extractable serving table
- AISI 304 s/s protective rails
- Weight: 29 kg



GOLD SERIES GUERIDON TROLLEYS

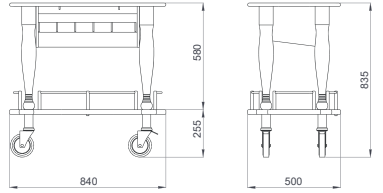

GLGR 122

- Dış Ölçüler :840x500x835 mm
- Ara bölmeli çatal-kaşık-bıçak hazneli
- Kenarlıklar AISI 304 s/s mil
- Ağırlık :33 kg
- Dimensions: 840x500x835 mm
- Holder for cutlery with compartments under upper shelf
- AISI 304 s/s protective rails
- Weight: 33 kg

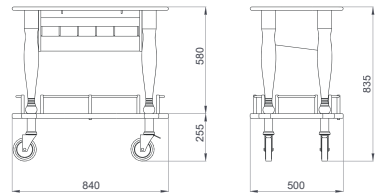

GLGR 132

- Dış Ölçüler : 840x500x835 mm
- Ara bölmeli çatal-kaşık-bıçak hazneli
- Sürgülü tabla
- Kenarlıklar AISI 304 s/s mil
- Ağırlık :34 kg
- Dimensions: 840x500x835 mm
- Holder for cutlery with compartments under upper shelf
- Extractable serving table
- AISI 304 s/s protective rails
- Weight: 34 kg



GOLD SERİSİ AKSESUARLAR



ŞİŞE TUTUCU
BOTTLES HOLDER
GSS 0289 - (39x50x18 cm)



AKRİLİK BUZ KOVASI
ACRYLIC ICE BUCKET
SSA 0102 - (30x15x21 cm)



AKRİLİK ŞİŞE SOĞUTUCU
ACRYLIC BOTTLE COOLER
SSA 0103 - (Ø21x21 cm)



AKRİLİK ŞİŞE SOĞUTUCU
ACRYLIC BOTTLE COOLER
SSA 0105 - (Ø13x22 cm)



AKRİLİK ŞİŞE SOĞUTUCU
ACRYLIC BOTTLE COOLER
SSA 0106 - (Ø13x14 cm)



ÇİFT CİDARLI S/S BUZ KOVASI
S/S ICE BUCKET DOUBLE - WALLED
SSA 0107 - (Ø15x20 cm)

GOLD SERIES ACCESSORIES



BUZ AKÜSÜ
EUTECTIC COOLING PACKS
SSA 0201 - (16,5x9x2 cm)
SSA 0202 - (16,5x9x3 cm)



ÇİN SALATA KASESİ
CHINA SALAD BOWLS
SSA 0401- (Ø15 cm)
SSA 0402- (Ø12 cm)



BAHARAT KAPLARI SETİ
SPICE CONTAINERS SET
SSA 0410 - (50x13x10 cm)

SILVER SERİSİ SERVİS ARABALARI

Restorantınızı tamamlayacak modern hatlara sahip Silver Serisi doğal kaplama gövde ve AISI 304 paslanmaz çelik ayaklar ve aksesuarlar ile donatılmıştır.

A very modern line to complete your restaurant. Silver serie is made of wood veneer on shelf and sides and AISI 304 stainless steel legs and metal accessories.

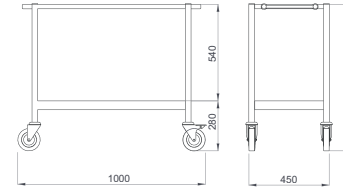

SLSA 102

- Dış Ölçüler : 1000x450x820 mm
- AISI 304 s/s boru karkas ve kenarlıklar
- Ağırlık : 18 kg

- Dimensions : 1000x450x820 mm
- AISI 304 s/s tube frames and shelf edges
- Weight : 18 kg

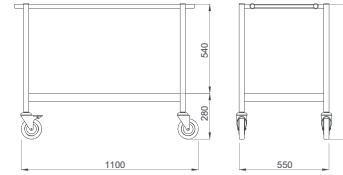

SLSA 112

- Dış Ölçüler : 1100x550x850 mm
- AISI 304 s/s boru karkas ve kenarlıklar
- Ağırlık : 22 kg

- Dimensions : 1100x550x850 mm
- AISI 304 s/s tube frames and shelf edges
- Weight : 22 kg



SILVER SERIES SERVING TROLLEYS

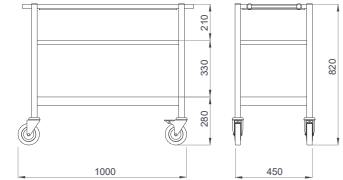

SLSA 103

- Dış Ölçüler : 1000x450x820 mm
- AISI 304 s/s boru karkas ve kenarlıklar
- Ağırlık : 23 kg

- Dimensions : 1000x450x820 mm
- AISI 304 s/s tube frames and shelf edges
- Weight : 23 kg

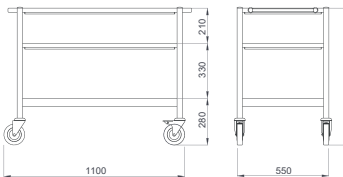

SLSA 113

- Dış Ölçüler : 1100x550x820 mm
- AISI 304 s/s boru karkas ve kenarlıklar
- Ağırlık : 28 kg

- Dimensions : 1100x550x820 mm
- AISI 304 s/s tube frames and shelf edges
- Weight : 28 kg



Uyarı: Direkt güneş altında, yağmur ve deniz rüzgarına karşı kullanım önerilmez.

Warning: Not recommended for usage under direct sunlight, rain or sea wind.

SILVER SERİSİ

SERVİS ARABALARI

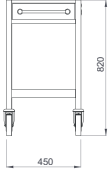
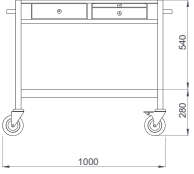

SLSA 114

- Dış Ölçüler : 1100x450x820 mm
- AISI 304 s/s boru karkas ve kenarlıklar
- 2 x çekmece ve sürgülü tabla
- Ağırlık : 30 kg
- Dimensions : 1100x450x820 mm
- AISI 304 s/s tube frames and shelf edges
- 2 x drawers, extractable serving table
- Weight : 30 kg



SILVER SERIES

SERVING TROLLEYS

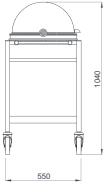
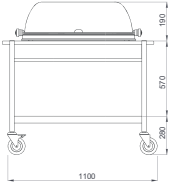

SLSA 115

- Dış Ölçüler : 1100x550x850/1040 mm
- AISI 304 s/s boru karkas ve kenarlıklar
- Ağırlık : 48 kg
- Dimensions : 1100x550x850/1040 mm
- AISI 304 s/s tube frames and shelf edges
- Weight : 48 kg



SILVER SERİSİ

ŞARAP TEŞHİR ARABALARI

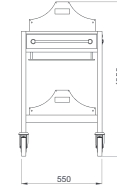
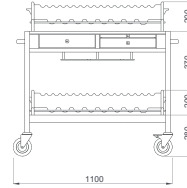

SLST 102

- Dış Ölçüler : 1100x550x850/1050 mm
- 2 x çekmece ve sürgülü tabla
- Üst tabla ve alt tabla üzerinde seyyar ahşap şişelik
- Plexi glass bardaklık
- Ağırlık : 48 kg

- Dimensions : 1100x550x850/1050 mm
- 2 x drawers, extractable serving table
- Mobile wooden bottle holders on both upper and lower shelves
- Plexiglass stand with catches for holding glass es under upper shelf
- Weight : 48 kg



SILVER SERIES

WINE DISPLAY TROLLEYS

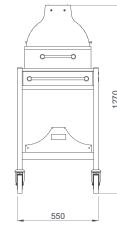
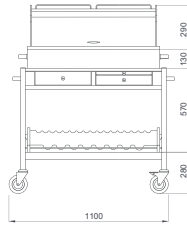

SLST 112

- Dış Ölçüler : 1100x550x850/1270 mm
- İki taraftan sürgülü açılabilir pleksi glass camekan, ahşap servis rafı
- 2 x çekmece ve sürgülü tabla
- Üst tabla ve alt tabla üzerinde seyyar şişelik, plexi glass bardaklık
- Ağırlık : 54 kg

- Dimensions : 1100x550x850/1270 mm
- Plexiglass roll top with lids opening from both sides on upper shelf, wooden serving shelf on plexiglass roll top
- 2 x drawers, extractable serving table
- Mobile wooden bottle holders on both upper and lower shelves stand with catch es for holding glasses under upper shelf
- Weight : 54 kg



SILVER SERİSİ

ŞARAP TEŞHİR ARABALARI

SLST 312 (+5/15°C)

- Dış Ölçüler : 1100x550x850/1270 mm
- Kompresör soğutma sistemi (R 404A - 250W-230v 1N AC 50 Hz)
- İki taraftan sürgülü açılabilir plexiglass camekan, ahşap servis rafı
- 2 x çekmece ve sürgülü tabla, plexiglass bardaklık
- Alt tablada seyyar şişelik
- Ağırlık : 85 kg

- Dimensions : 1100x550x850/1270 mm
- Cooling system with compressor (R 404A - 250W-230 v 1N AC 50 Hz)
- Plexiglass roll top with lids opening from both sides on upper shelf, wooden serving shelf on plexiglass roll top
- 2 x drawers, extractable serving table
- Mobile bottle holder on lower shelf
- Weight : 85 kg



SILVER SERIES

WINE DISPLAY TROLLEYS

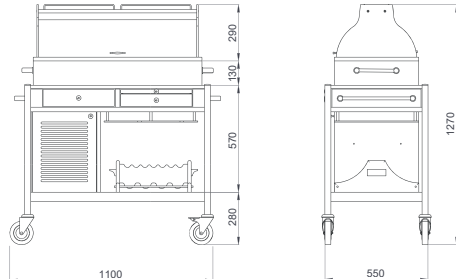

SILVER SERİSİ

LİKÖR VE ŞARAP SERVİS ARABALARI

SLIS 102

- Dış Ölçüler : 1100x550x850/1150 mm
- AISI 304 s/s kenarlık, itme kulbu, ayaklar
- 2 x çekmece ve sürgülü tabla, plexiglass bardaklık
- Buz ve şampanya kovaları opsiyoneldir
- Ağırlık : 45 kg

- Dimensions : 1100x550x850/1150 mm
- AISI 304 s/s protective rail on upper shelf, tube handle for pushing and legs
- 2 x drawers, extractable serving table, stand for glasses
- Ice buckets and champagne buckets are optional
- Weight : 45 kg

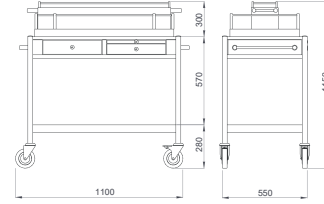

SLIS 112

- Dış Ölçüler : 1100x550x850/1060 mm
- AISI 304 s/s kenarlık, itme kulbu, ayaklar
- 2 x çekmece ve sürgülü tabla, plexiglass bardaklık
- Buz ve şampanya kovası opsiyoneldir
- Ağırlık : 42 kg

- Dimensions : 1100x550x850/1060 mm
- AISI 304 s/s protective rail on upper shelf, tube handle for pushing and legs
- 2 x drawers, extractable serving table, stand for glasses
- Ice buckets and, champagne bucket are optional
- Weight : 42 kg

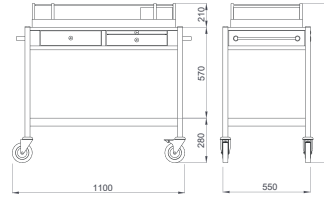

SILVER SERIES

LIQUOR AND WINE SERVING TROLLEYS

SLIS 122

- Dış Ölçüler : 750x800/1320 mm
- AISI 304 s/s kenarlık, itme kulbu, ayaklar
- Şampanya kovası opsiyoneldir
- Ağırlık : 38 kg

- Dimensions : Ø750x750x800/1320 mm
- AISI 304 s/s protective rail on upper shelf, tube handle for pushing and legs
- Champagne bucket is optional
- Weight : 38 kg

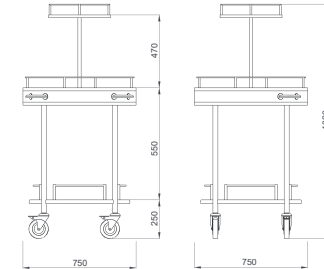

SILVER SERİSİ

PEYNİR VE TATLI SERVİS ARABALARI

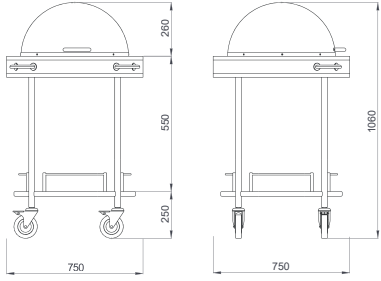

SLCS 102

- Dış Ölçüler : 0750x800/1060 mm
- Corian servis yüzeyi Ø 520 mm
- 180° döner plexiglass camakan
- AISI 304 s/s itme kulbu, ayaklar, kenarlıklar
- Sürgülü tabla
- Ağırlık : 41 kg

- Dimensions : 0750x750x800/1060 mm
- Corian serving surface Ø520 mm
- Plexiglass roll top adjustable to 180 degrees
- AISI 304 s/s tube handle for pushing, legs and protective rails
- Extractable serving table
- Weight : 41 kg

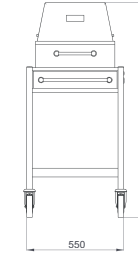
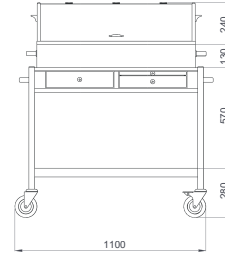

SLCS 202

- Dış Ölçüler : 1100x550x850/1220 mm
- Buz akülü soğutma sistemi
- Perfore AISI 304 s/s soğutma yüzeyi
- Yanları aışap korumalı iki taraftan açılabilir plexiglass camakan
- AISI 304 s/s itme kulbu, ayaklar, kenarlıklar
- 2 x çekmece ve sürgülü tabla,
- Havuz Ölçüsü : 800x340x85 mm
- Ağırlık : 50 kg

- Dimensions : 1100x550x850/1220 mm
- Cooling system with eutectic cooling pack
- AISI 304 s/s perforated cooling surface
- Plexiglass top with wooden sides and lids opening from both sides
- AISI 304 s/s tube handle for pushing, legs and protective rails
- 2 x drawers, extractable serving table
- Well dimensions: 800x340x85 mm
- Weight : 50 kg

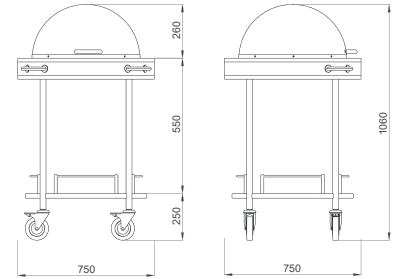

SLCS 112

- Dış Ölçüler : 0750x800/1060 mm
- Buz akülü soğutma sistemi
- Ø520 mm perfore soğutma yüzeyi AISI 304 s/s
- 180° döner plexiglass camakan
- AISI 304 s/s itme kulbu, ayaklar, kenarlıklar
- Sürgülü tabla
- Ağırlık : 38 kg

- Dimensions : 0750 x750x800/1060 mm
- Cooling system with eutectic cooling pack
- AISI 304 s/s perforated cooling surface Ø520 mm
- Plexiglass roll top adjustable to 180 degrees
- AISI 304 s/s tube handle for pushing, legs and protective rails
- Extractable serving table
- Weight : 38 kg

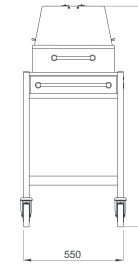
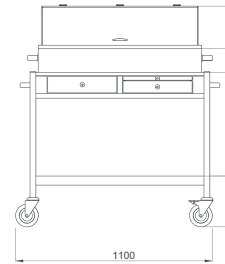

SLCS 212

- Dış Ölçüler : 1100x550x850/1220 mm
- Buz akülü soğutma sistemi
- Perfore AISI 304 s/s soğutma yüzeyi
- İki taraftan açılabilir, plexiglass camakan
- AISI 304 s/s itme kulbu, ayaklar, kenarlıklar
- 2 x çekmece ve sürgülü tabla,
- Havuz Ölçüsü : 800x340x85 mm
- Ağırlık : 49 kg

- Dimensions : 1100x550x850/1220 mm
- Cooling system with eutectic cooling pack
- AISI 304 s/s perforated cooling surface
- Plexiglass top with lids opening from both sides
- AISI 304 s/s tube handle for pushing, legs and protective rails
- 2 x drawers, extractable serving table
- Well dimensions: 800x340x85 mm
- Weight : 49 kg



SILVER SERİSİ

PASTA ARABALARI

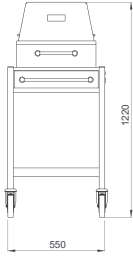
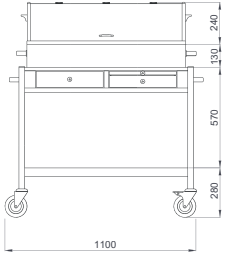

SLPS 102

- Dış Ölçüler : 1100x550x850/1220 mm
- Buz akülü soğutma sistemi
- Perfore AISI 304 s/s soğutma yüzeyi, itme kulbu, ayaklar
- İki taraftan açılabilir yanları ahşap kaplı plexiglass camekan
- 2 x çekmece ve sürgülü tabla,
- Havuz Ölçüsü : 800x340x85 mm
- Ağırlık : 50 kg

- Dimensions:1100x550x850/1220 mm
- Cooling system with eutectic cooling pack
- AISI 304 s/s perforated cooling surface, tube handle for pushing and legs
- Wooden serving shelf on plexiglass top with lids opening from both sides
- 2 x drawers, extractable serving table
- Well dimensions : 800x340x85 mm
- Weight : 50 kg

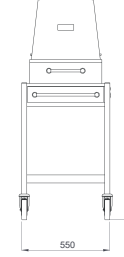
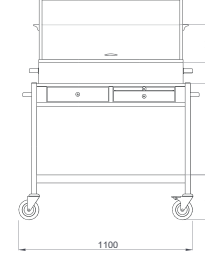

SLPS 202

- Dış Ölçüler : 1100x550x850/1380 mm
- Perfore AISI 304 s/s soğutma yüzeyi, itme kulbu, ayaklar
- İki taraftan açılabilir 2 katlı, yanları ahşap kaplı plexiglass camekan
- 2 x çekmece ve sürgülü tabla,
- Havuz Ölçüsü : 800x340x85 mm
- Ağırlık : 55 kg

- Dimensions : 1100x550x850/1380 mm
- AISI 304 s/s perforated cooling surface, tube handle for pushing and legs
- Double-storeyed plexiglass top with wooden sides and lids opening from both sides
- 2 x drawers, extractable serving table
- Well dimensions : 800x340x85 mm
- Weight : 55 kg

SILVER SERIES

PASTRY TROLLEYS

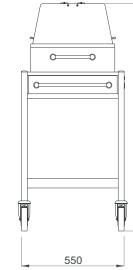
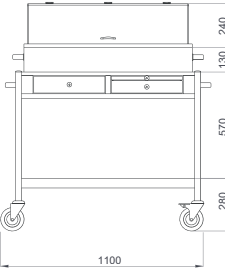

SLPS 112

- Dış Ölçüler : 1100x550x850/1220 mm
- Buz akülü soğutma sistemi
- Perfore AISI 304 s/s soğutma yüzeyi, itme kulbu, ayaklar
- İki taraftan sürgülü açılabilir plexiglass camekan
- 2 x çekmece ve sürgülü tabla,
- Havuz Ölçüsü : 800x340x85 mm
- Ağırlık : 49 kg

- Dimensions : 1100x550x850/1220 mm
- Cooling system with eutectic cooling pack
- AISI 304 s/s perforated cooling surface, tube handle for pushing and legs
- Plexiglass top with lids opening from both sides
- 2 x drawers, extractable serving table
- Well dimensions : 800x340x85 mm
- Weight : 49 kg

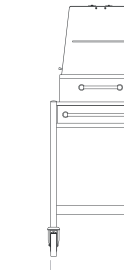
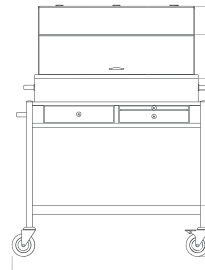

SLPS 222

- Dış Ölçüler : 1100x550x850/1380 mm
- Perfore AISI 304 s/s soğutma yüzeyi, itme kulbu, ayaklar
- İki taraftan açılabilir 2 katlı, plexiglass camekan
- 2 x çekmece ve sürgülü tabla,
- Havuz Ölçüsü : 800x340x85 mm
- Ağırlık : 52 kg

- Dimensions : 1100x550x850/1380 mm
- AISI 304 s/s perforated cooling surface, tube handle for pushing and legs
- Double-storeyed plexiglass top with lids opening from both sides
- 2 x drawers, extractable serving table
- Well dimensions : 800x340x85 mm
- Weight : 52 kg

SILVER SERİSİ

PASTA ARABALARI

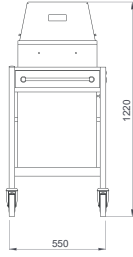
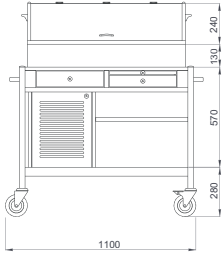

SLPS 303 (+4 /+10°C)

- Dış Ölçüler : 1100x550x850/1220 mm
- Kompresörlü soğutma sistemi (R404A-250W-230v 1N AC 50 Hz)
- Perfore AISI 304 s/s soğutma yüzeyi, itme kulbu, ayaklar
- İki taraftan sürgülü açılabilir yanları ahşap plexi glass camekan
- 2 x çekmece ve sürgülü tabla,
- Havuz Ölçüsü : 800x340x85 mm
- Ağırlık : 93 kg

- Dimensions : 1100x550x850/1220 cm
- Cooling system with compressor (R404A-250W-230v1N AC 50 Hz)
- AISI 304 s/s perforated cooling surface, tube handle for pushing and legs
- Plexiglass top with wooden sides and lids opening from both sides
- 2 x drawers, extractable serving table
- Well dimensions : 800x340x85 mm
- Weight : 93 kg

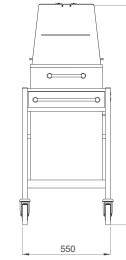
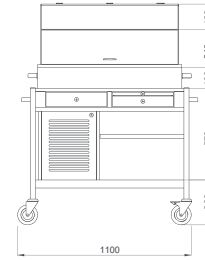

SLPS 322 (+4/+10°C)

- Dış Ölçüler : 1100x550x850/1380 mm
- Kompresörlü soğutma sistemi (R404A-250W-230v 1N AC 50 Hz)
- Perfore AISI 304 s/s soğutma yüzeyi, itme kulbu, ayaklar
- İki taraftan açılabilir 2 katlı, plexiglass camekan
- 2 adet çekmece, bir adet sürgülü tabla
- Havuz Ölçüsü : 800x340x85 mm
- Ağırlık : 95 kg

- Dimensions : 1100x550x850/1380 mm
- Cooling system with compressor (R404A-250W-230v 1N AC 50 Hz)
- AISI 304 s/s perforated cooling surface, tube handle for pushing and legs
- Double-storeyed plexiglass top with lids opening from both sides
- 2 pcs of drawers, extractable serving table
- Well dimensions : 800x340x85 mm
- Weight : 95 kg

SILVER SERIES

PASTRY TROLLEYS

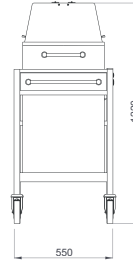
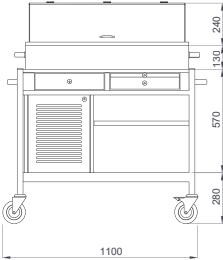

SLPS 313 (+4/+10°C)

- Dış Ölçüler : 1100x550x850/1220 mm
- Kompresörlü soğutma sistemi (R404A-250W-230v 1N AC 50 Hz)
- Perfore AISI 304 s/s soğutma yüzeyi, itme kulbu, ayaklar
- İki taraftan açılabilir plexiglass camekan
- 2 x çekmece ve sürgülü tabla,
- Havuz Ölçüsü : 800x340x85 mm
- Ağırlık : 90 kg

- Dimensions : 1100x550x850/1220 mm
- Cooling system with compressor (R404A-250W-230v 1N AC 50 Hz)
- AISI 304 s/s perforated cooling surface, tube handle for pushing and legs
- Plexiglass top with lids opening from both sides
- 2 x drawers, extractable serving table
- Well dimensions : 800x340x85 mm
- Weight : 90 kg

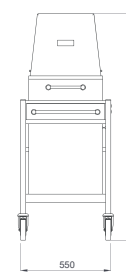
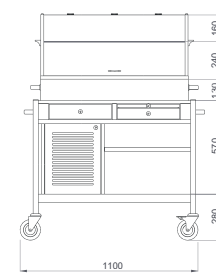

SLPS 333 (+4 /+10°C)

- Dış Ölçüler : 1100x550x850/1380 mm
- Kompresörlü soğutma sistemi (R404A-250W-230v 1N AC 50 Hz)
- Perfore AISI 304 s/s soğutma yüzeyi, itme kulbu, ayaklar
- İki taraftan açılabilir 2 katlı, yanları ahşap kaplı, plexiglass camekan
- 2 adet çekmece, bir adet sürgülü tabla
- Havuz Ölçüsü : 800x340x85 mm
- Ağırlık : 97 kg

- Dimensions : 1100x550x850/1380 mm
- Cooling system with compressor (R404A-250W-230v 1N AC 50 Hz)
- AISI 304 s/s perforated cooling surface, tube handle for pushing and legs
- Double-storeyed plexiglass top with wooden sides and lids opening from both sides
- 2 pcs of drawers, extractable serving table
- Well dimensions : 800x340x85 mm
- Weight : 97 kg

SILVER SERİSİ

MEZE ARABALARI

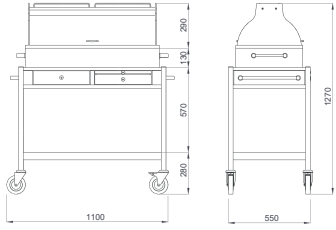

SLMS 102

- Dış Ölçüler : 1100x550x850/1270 mm
- Buz akülü soğutma sistemi
- AISI 304 s/s itme kulbu, ayaklar, kenarlıklar
- Çift taraflı sürgülü açılabilen plexiglass camcan, ahşap servis rafı
- 2 x çekmece ve sürgülü tabla,
- 4x GN 1/3 + 2 x GN 1/6 kapasiteli
- Havuz Ölçüsü : 800x340x85 mm
- Ağırlık : 48 kg
- Dimensions : 1100x550x850/1270 mm
- Cooling system with eutectic cooling pack
- AISI 304 s/s tube handle for pushing, legs and protective rails
- Plexiglass top with lids opening from both sides, wooden serving shelf on plexiglass top
- 2 x drawers, extractable serving table
- 4x GN 1/3 + 2 X GN 1/6 container capacity
- Well dimensions : 800x340x85 mm
- Weight : 48 kg



SILVER SERIES

APPETIZER TROLLEYS

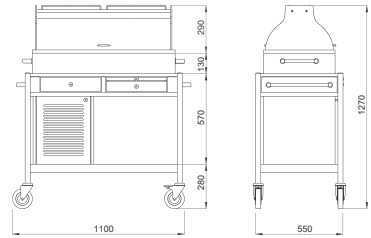

SLMS 112 (+4/+10°C)

- Dış Ölçüler : 1100x550x850/1270 mm
- Kompresörlü soğutma sistemi (R 404A - 250 W-230v 1N AC 50 Hz)
- AISI 304 s/s kenarlık, itme kulbu, ayaklar
- İki taraftan sürgülü açılabilir plexiglass camcan, ahşap servis rafı
- 2 x çekmece ve sürgülü tabla,
- 4x GN 1/3 + 2 X GN 1/6 küvet kapasiteli
- Havuz Ölçüsü : 800x340x85 mm
- Ağırlık : 91 kg
- Dimensions : 1100x550x850/1270 mm
- Cooling system with compressor (R404A-250W-230v 1N AC 50 Hz)
- AISI 304 s/s tube handle for pushing, legs and protective rails
- Plexiglass top with lids opening from both sides, wooden serving shelf on plexiglass top
- 2 x drawers, extractable serving table
- 4x GN 1/3 + 2 X GN 1/6 container capacity
- Well dimensions : 800x340x85 mm
- Weight : 91 kg



SILVER SERİSİ

SICAK MEZE ARABALARI



SILVER SERIES

HOT APPETIZER TROLLEYS

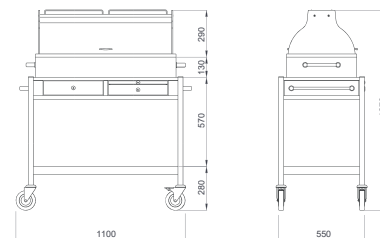

SLSS 102 (+30/+110°C)

- Dış Ölçüler : 1100x550x850/1270 mm
- İki taraftan sürgülü açılabilir, plexi glass camcan, ahşap servis rafı
- Silikon ısıtıcı AISI 304 s/s havuz
- Dijital göstergeli termostat
- 4 x GN 1/3 + 2 x GN 1/6 kapasiteli
- Havuz Ölçüsü : 800x340x85 mm
- Ağırlık : 48 kg
- Dimensions : 1100x550x850/1270 mm
- Plexiglass top with lids opening from both sides, Wooden serving shelf on plexiglass top
- AISI 304 s/s well heated with etched foil heating element.
- Thermostat with digital indicator
- 4 x GN 1/3 + 2 X GN 1/6 container capacity
- Well dimensions : 800x340x85 mm
- Weight : 48 kg



Uyarı : Isıtıcı açık durumda iken bularlaşmayı önlemek için kapağı açık bırakın.
Warning : Keep the lid open while the heating is on to prevent evaporation.

SILVER SERİSİ

BALIK TEŞHİR ARABALARI

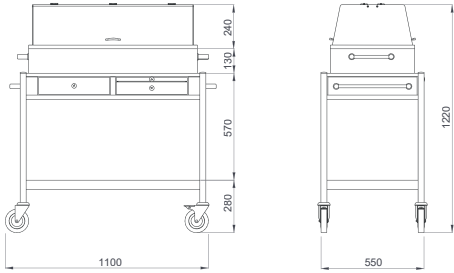

SLBT 112

- Dış Ölçüler : 1100x550x850/1220 mm
- Buz havuzlu soğutma sistemi
- AISI 304 s/s soğutma havuzu, itme kulbu ayaklar
- İki taraftan açılabilir plexi glass camekan
- 2 x çekmece ve sürgülü tabla
- Havuz Ölçüsü : 800x340x85 mm
- Ağırlık : 49 kg

- Dimensions : 1100x550x850/1220 mm
- Cooling system with eutectic cooling pack
- AISI 304 s/s tube handle for pushing
- Plexiglass top with lids opening from both sides
- 2 x drawers, extractable serving table
- Well dimensions : 800x340x85 mm
- Weight : 49 kg

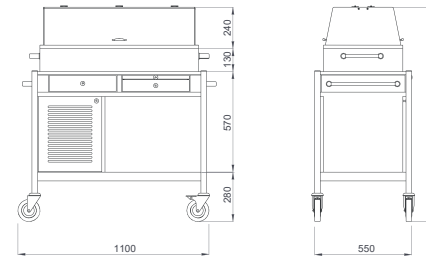

SLBT 312 (-2/0°C)

- Dış Ölçüler : 1100x550x850/1220 mm
- Kompresör soğutma sistemli (R404A-250w-230v 1N AC 50 Hz)
- AISI 304 s/s soğutma havuzu, itme kulbu, ayaklar
- İki taraftan açılabilir plexi glass camekan
- 2 x çekmece ve sürgülü tabla
- Havuz Ölçüsü : 800x340x85 mm
- Ağırlık : 91 kg

- Dimensions : 1100x550x850/1220 mm
- Cooling system with compressor (R404A-250w-230v 1N AC 50 Hz)
- AISI 304 s/s cooling well, tube handle for pushing and legs
- Plexiglass top with lids opening from both sides
- 2 x drawers, extractable serving table
- Well dimensions : 800x340x85 mm
- Weight : 91 kg



SILVER SERIES

FISH DISPLAY TROLLEYS



SILVER SERİSİ

FLAMBE ARABALARI

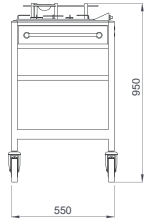
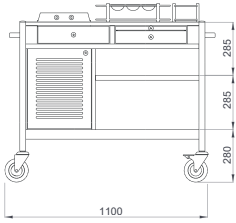

SLFA 103

- Dış Ölçüler : 1100x550x850/950 mm
- Sıcak tavaların ahşaba zarar vermesini önleyen 4 sıra krom mil
- 2 ocaklı AISI 304 s/s gövdeli , çakmaklı , gazlı ocak
- AISI 304 s/s kenarlıklar ve itme kulbu, ayaklar
- 2 x çekmece ve sürgülü tabla
- Tüp dolabı (tüp hariç)
- AISI 304 s/s mil yağlık-şişelik/baharatlık (opsiyonel)
- Ağırlık : 64 kg

- Dimensions : 1100x550x850/950 mm
- 4 pcs of metal rods to prevent hot pans give damage to the wooden surface
- Two-headed AISI 304 s/s burner with gas and lighting device
- AISI 304 s/s tube handle for pushing and legs
- 2 x drawers, extractable serving table
- Wooden cabinet for gas cylinder on lower shelf (without gas cylinder)
- AISI 304 s/s bottle holders, spice containers are optional
- Weight : 64 kg

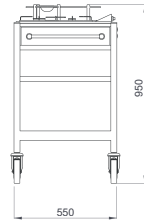
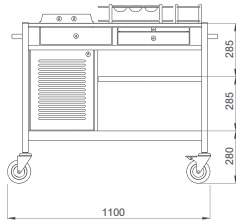

SLFP 103

- Dış Ölçüler : 1100x550x850/950 mm
- Üst tabla üzeri AISI 304 s/s sac
- 2 ocaklı AISI 304 s/s gövdeli , çakmaklı , gazlı ocak
- AISI 304 s/s kenarlıklar ve itme kulbu, ayaklar
- 2 x çekmece ve sürgülü tabla
- Tüp dolabı (tüp hariç)
- AISI 304 s/s mil yağlık-şişelik / sosluk (opsiyonel)
- Ağırlık : 67 kg

- Dimensions : 1100x550x850/950 mm
- Upper work surface with AISI 304 s/s veneer
- Two-headed AISI 304 s/s burner with gas and lighting device
- AISI 304 s/s tube handle for pushing and legs
- 2 x drawers, extractable serving table
- Wooden cabinet for gas cylinder on lower shelf (without gas cylinder)
- AISI 304 s/s bottles holders, salad dressing containers are optional
- Weight : 67 kg

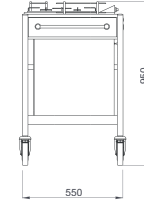
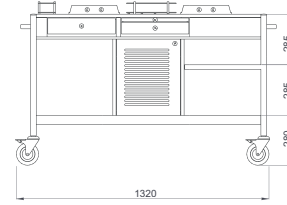

SLFA 203

- Dış Ölçüler : 1320x550x850/950 mm
- Sıcak tavaların ahşaba zarar vermesini önleyen 4 sıra krom mil
- 2 ocaklı AISI 304 s/s gövdeli , çakmaklı , gazlı ocak
- AISI 304 s/s kenarlıklar ve itme kulbu, ayaklar
- 2 x çekmece ve sürgülü tabla
- Tüp dolabı (tüp hariç)
- AISI 304 s/s mil yağlık-şişelik /baharatlık (opsiyonel)
- Ağırlık : 80 kg

- Dimensions : 1320x550x850/950 mm
- 4 pcs of metal rods to prevent hot pans give damage to the wooden surface
- 2 pcs two-headed AISI 304 s/s burner with gas and lighting device
- AISI 304 s/s tube handle for pushing and legs
- 2 x drawers, extractable serving table
- Wooden cabinet for gas cylinder on lower shelf (without gas cylinder)
- AISI 304 s/s bottles holders, spice containers are optional
- Weight : 80 kg

SILVER SERIES

FLAMBE TROLLEYS



SILVER SERİSİ

GUERİDON ARABALARI

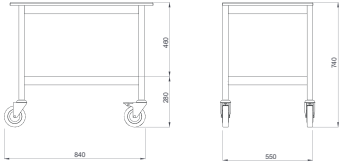

SLGR 102

- Dış Ölçüler : 840x550x740 mm
- AISI 304 s/s kenarlıklar, ayaklar
- Ağırlık : 25 kg
- Dimensions : 840x550x740 mm
- AISI 304 s/s protective rails and legs
- Weight : 25 kg

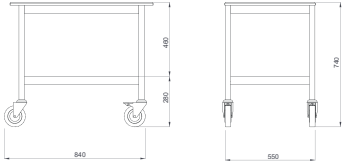

SLGR 112

- Dış Ölçüler : 840x550x740 mm
- AISI 304 s/s kenarlıklar, ayaklar
- Sürgülü tabla
- Ağırlık : 26 kg
- Dimensions : 840x550x740 mm
- AISI 304 s/s protective rails and legs
- Extractable serving table
- Weight : 26 kg

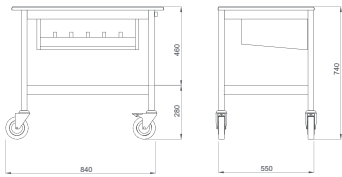

SLGR 122

- Dış Ölçüler : 840x550x740 mm
- AISI 304 s/s kenarlıklar, ayaklar
- Üst tabla altında çatal, kaşık ve bıçak için bölme
- Ağırlık : 32 kg
- Dimensions : 840x550x740 mm
- AISI 304 s/s protective rails and legs
- Holder for cutlery under upper shelf
- Weight : 32 kg

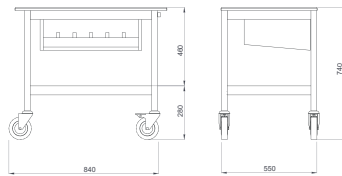

SLGR 132

- Dış Ölçüler : 840x550x740 mm
- AISI 304 s/s kenarlıklar, ayaklar
- Sürgülü tabla
- Üst tabla altında çatal, kaşık ve bıçak için bölme
- Ağırlık : 33 kg
- Dimensions : 840x550x740 mm
- AISI 304 s/s protective rails and legs
- Extractable serving table
- Holder for cutlery under upper shelf
- Weight : 33 kg



SILVER SERIES

GUERIDON TROLLEYS



SILVER SERİSİ

AKSESUARLAR



BALIK HAVUZU / WELL FOR FISH
SSS 0127.....90/102x45x14 cm



SICAK HAVUZ / HOT WELL
SSS 0160.....90/102x45x16 cm



MEZE HAVUZU / WELL FOR APPETIZERS
SSS 0146.....90/102x45x16 cm



PEYNİR HAVUZU / WELL FOR CHEESE
SSS 0148.....90/102x45x14 cm



PASTA HAVUZU / WELL FOR PASTRY
SSS 0150.....90/102x45x14 cm



LİKÖR VE ŞARAP SETİ / LIQUEUR AND WINE SET
SSS 0309.....90x45x21 cm



LİKÖR VE ŞARAP SETİ / LIQUEUR AND WINE SET
SSS 0311.....90x45x30 cm



ŞARAP HAVUZU / WELL FOR WINE
SSS 0308.....90/102x45x43 cm



ŞARAP SETİ / WINE SET
SSS 0299.....40x45x20 cm



ŞARAP SETİ / WINE SET
SSS 0302.....90x45x20 cm



TEK KATLI PLEKSİĞLAS KAPAK /
SINGLE-STOREY PLEXIGLASS TOP
SSS 0110.....90x45x24 cm



AHŞAP KENARLI TEK KATLI PLEKSİĞLAS KAPAK /
SINGLE-STOREY PLEXIGLASS TOP WITH WOODEN
SIDES
SSS 0112.....90x45x24 cm



ÜST SERVİS RAFI VE YANLARI AHŞAP
PLEKSİĞLAS KAPAK
PLEXIGLASS TOP WITH WOODEN SERVING
SHELF ON TOP-WOODEN SIDES
SSS 0206.....90x45x30 cm



PLEKSİĞLAS KAPAK SETİ / PLEXIGLASS DISPLAY
SET
SSS 0208.....86x43x22 cm



AHŞAP KENARLI PLEKSİĞLAS KAPAK SETİ /
PLEXIGLASS DISPLAY SET WOODEN SIDES
SSS 0210.....86x43x23 cm

SILVER SERIES

ACCESSORIES



ÇİFT KATLI PLEKSİĞLAS KAPAK /
2 STOREY PLEXIGLASS TOP
SSS 0115.....90x45x40 cm



AHŞAP KENARLI ÇİFT KATLI PLEKSİĞLAS KAPAK /
2 STOREY PLEXIGLASS TOP WITH WOODEN SIDES
SSS 0117.....90x45x40 cm



ÜST SERVİS RAFI AHŞAP PLEKSİĞLAS KAPAK /
PLEXIGLASS TOP WITH WOODEN SERVING
SHELF ON TOP
SSS 0203.....90x45x30 cm



ÇİFT CİDARLI S/S BUZ KOVASI
S/S ICE BUCKET DOUBLE-SKIN
SSA 0107.....Ø15x20 cm



S/S GN KAP(kapaksız) / S/S GN CONTAINER
(without lid)
GN 1/3.....32.5x10.7x6.5 cm



S/S GN KAP(kapaksız) / S/S GN CONTAINER
(without lid)
GN 1/6.....17.6x16.2x6.5 cm



S/S GN KAPAK / S/S GN LID
GN 1/3



S/S GN KAPAK / S/S GN LID
GN 1/6



BAHARAT KAPLARI SETİ / SPICE CONTAINERS SET
SSA 0410.....50x13x10 cm



AKRİLİK BUZ KOVASI /
ACRYLIC ICE BUCKET
SSA 0102.....30x15x21 cm



AKRİLİK ŞİŞE SOĞUTUCU /
ACRYLIC BOTTLE COOLER
SSA 0103.....Ø21x21 cm



AKRİLİK ŞİŞE SOĞUTUCU /
ACRYLIC BOTTLE COOLER
SSA 0105.....Ø13x22 cm



AKRİLİK BUZ KOVASI /
ACRYLIC ICE BUCKET
SSA 0106.....Ø13x14 cm



BUZ AKÜSÜ / EUTECTIC COOLING PACKS
SSA 0201.....16,5x9x2 cm
SSA 0202.....16,5x9x3 cm



MUTFAK ARABALARI KITCHEN TROLLEYS



GN TEPŞİ TAŞIMA ARABALARI GN TRAY TROLLEYS

Geniş ürün yelpazesine olan AISI 304 Paslanmaz çelik arabalar ile kurumunuzdaki tüm ihtiyaçlarınızı karşılayabilirsiniz. Gastronom konteyner, tepsi ve tabaklarınız kolay ve güvenli bir şekilde taşıyabilirsiniz.

Tek yapmanız gereken işinize uygun arabayı seçmek!

Wide range of AISI 304 stainless steel trolley selection offers safe and easy transportation of GN containers, trays and dishes.

All you have to do is to select the right trolley!

L RAYLI GN KÜVET TAŞIMA ARABALARI

L- RAILS GN CONTAINER TRANSPORT TROLLEYS

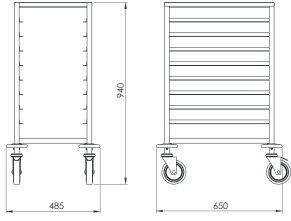

LRCT 108

- Dış Ölçüler : 485x650x940 mm
- 25x25 mm AISI 304 s/s profil
- Üst tabla 1 mm AISI 304 s/s sac
- Antişok plastik disk tampon
- L Raylar arkadan ve önden stoperlidir
- Fırın içinde kullanılmaz
- 1/1 GN 8

- Dimensions: 485x650x940 mm
- 25x25 mm AISI 304 s/s tubular construction
- 1 mm AISI 304 s/s top shelf
- Shock-proof plastic disc bumpers
- L rails with stop bars at both sides
- Not for bakery usage.
- 1/1 GN 8

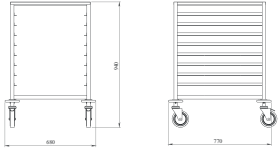

LRCT 208

- Dış Ölçüler : 680x770x940 mm
- 25x25 mm AISI 304 s/s profil
- Üst tabla 1 mm AISI 304 s/s sac
- Antişok plastik disk tampon
- L Raylar arkadan ve önden stoperlidir
- Fırın içinde kullanılmaz
- 2/1 GN 8

- Dimensions : 680x770x940 mm
- 25x25 mm AISI 304 S/S tubular construction
- 1 mm AISI 304 s/s top shelf
- Shock-proof plastic disc bumpers
- L rails with stop bars at both sides
- Not for bakery usage.
- 2/1 GN 8

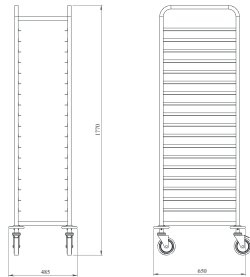

LRCT 118

- Dış Ölçüler : 485x650x1770 mm
- 25x25 mm AISI 304 s/s profil
- Antişok plastik disk tampon
- Fırın içinde kullanılmaz
- L Raylar önden stoperli
- Arkadan AISI 304 s/s mil ile emniyetli stoperlidir
- 1/1 GN 18

- Dimensions : 485x650x1770 mm
- 25x25 mm AISI 304 S/S tubular construction
- Shock-proof plastic disc bumpers
- Not for usage in bakery
- L rails with stop bars at front side
- AISI 304 s/s rod extra securing device at back side
- 1/1 GN 18

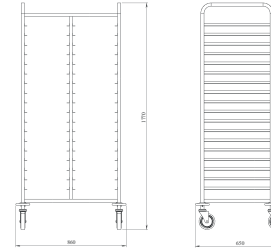

LRCT 118-D

- Dış Ölçüler : 860x650x1770 mm
- 25x25 mm AISI 304 s/s tüp
- Antişok plastik disk tampon
- Fırın içinde kullanılmaz
- L Raylar önden stoperli
- Arkadan AISI 304 s/s mil ile emniyetli stoperlidir
- 1/1 GN 18x2

- Dimensions : 860x650x1770 mm
- 25x25 mm AISI 304 s/s tubular construction
- Shock-proof plastic disc bumpers
- Not for bakery usage.
- L rails with stop bars at front side
- AISI 304 s/s rod extra securing device at back side
- 1/1 GN 18x2

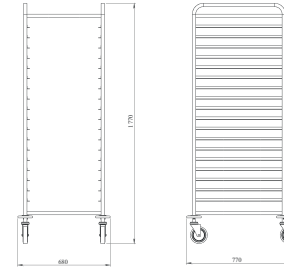

LRCT 218

- Dış Ölçüler : 680x770x1770 mm
- 25x25 mm AISI 304 s/s tüp
- Antişok plastik disk tampon
- Fırın içinde kullanılmaz
- Raylar önden stoperli
- Arkadan AISI 304 s/s mil ile emniyetli stoperlidir
- 2/1 GN 18

- Dimensions: 680x770x1770 mm
- 25x25 mm AISI 304 s/s tubular construction
- Shock-proof plastic disc bumpers
- Not for bakery usage.
- L rails with stop bars at front side
- AISI 304 S/S rod extra securing device at back side
- 2/1 GN 18



U RAYLI GN KÜVET TAŞIMA ARABALARI

U- RAILS GN CONTAINER TRANSPORT TROLLEYS

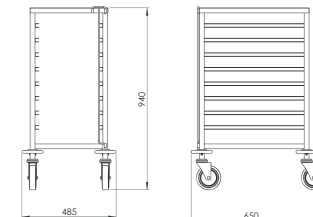

URCT 108

- Dış Ölçüler : 485x650x940 mm
- 25x25 mm AISI 304 s/s profile
- Üst tabla 1 mm AISI 304 s/s sac
- Antişok plastik disk tampon
- Fırın içinde kullanılmaz
- U Raylar önden ve arkadan stoperli
- 1/1 GN 8

- Dimensions : 485x650x940 mm
- 25x25 mm AISI 304 s/s tubular construction
- 1 mm AISI 304 s/s top shelf
- Shock-proof plastic disc bumpers
- Not for bakery usage.
- U rails with stop bars at both sides
- 1/1 GN 8



U RAYLI GN KÜVET TAŞIMA ARABALARI

U- RAILS GN CONTAINER TRANSPORT TROLLEYS

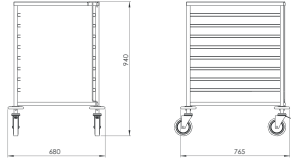

URCT 208

- Dış Ölçüler : 680x765x940 mm
 - 25x25 mm AISI 304 s/s profil
 - Üst tabla 1 mm AISI 304 s/s sac
 - Antişok plastik disk tampon
 - Fırın içinde kullanılmaz
 - U Raylar önden ve arkadan stoperli
 - 2/1 GN 8
- Dimensions : 680x765x940 mm
 - 25x25 mm AISI 304 s/s tubular construction
 - 1 mm AISI 304 s/s shelf
 - Shock-proof plastic disc bumpers
 - Not for bakery usage.
 - U rails with stop bars at both sides
 - 2/1 GN 8

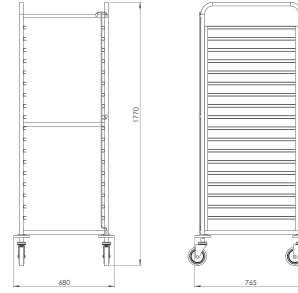

URCT 218

- Dış Ölçüler : 860x650x1770 mm
 - 25x25 mm AISI 304 s/s profil
 - Antişok plastik disk tampon
 - Fırın içinde kullanılmaz
 - U Raylar önden stoperli
 - Arkadan AISI 304 s/s mil ile emniyetli stoperlidir
 - 2/1 GN 18
- Dimensions: 66x85x168 cm
 - 25x25 mm AISI 304 s/s tubular construction
 - Shock-proof plastic disc bumpers
 - Not for bakery usage.
 - U rails with stop bars at front side
 - AISI 304 s/s rod extra securing device at back side
 - 2/1 GN 18



Z RAYLI GN KÜVET TAŞIMA ARABALARI

Z- RAILS GN CONTAINER TRANSPORT TROLLEYS

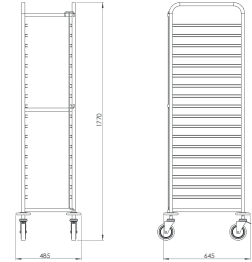

URCT 118

- Dış Ölçüler : 485x645x1770 mm
 - 25x25 mm AISI 304 s/s profil
 - Antişok plastik disk tampon
 - Fırın içinde kullanılmaz
 - U Raylar önden stoperli
 - Arkadan AISI 304 s/s mil ile emniyetli stoperlidir
 - 1/1 GN 18
- Dimensions : 485x645x1770 mm
 - 25x25 mm AISI 304 s/s tubular construction
 - Shock-proof plastic disc bumpers
 - Not for bakery usage.
 - U rails with stop bars at front side
 - AISI 304 s/s rod extra securing device at back side
 - 1/1 GN 18

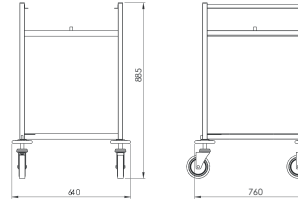

ZSCT 201

- Dış Ölçüler : 640x760x885 mm
 - 25x25 mm AISI 304 s/s profil
 - Üst tabla 1 mm AISI 304 s/s sac
 - Antişok plastik disk tampon
 - Fırın içinde kullanılmaz
 - 2/1 GN
- Dimensions : 640x760x885 mm
 - 25x25 mm AISI 304 s/s tubular construction
 - 1 mm AISI 304 s/s top shelf
 - Shock-proof plastic disc bumpers
 - Not for bakery usage.
 - 2/1 GN

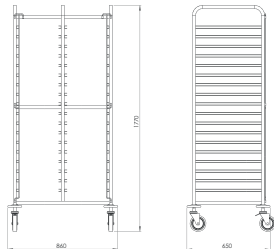

URCT 118D

- Dış Ölçüler : 860x650x1770 mm
 - 25x25 mm AISI 304 s/s profil
 - Antişok plastik disk tampon
 - Fırın içinde kullanılmaz
 - U Raylar önden stoperli
 - Arkadan AISI 304 s/s mil ile emniyetli stoperlidir
 - 1/1 GN 18x2
- Dimensions : 860x650x1770 mm
 - 25x25 mm AISI 304 s/s tubular construction
 - Shock-proof plastic disc bumpers
 - Not for bakery usage.
 - U rails with stop bars at front side
 - AISI 304 s/s rod extra securing device at back side
 - 1/1 GN 18x2

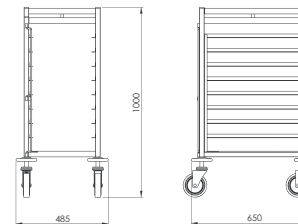

ZSCT 108

- Dış Ölçüler : 485x650x1000 mm
 - 25x25 mm AISI 304 s/s profil
 - Üst tabla 1 mm AISI 304 s/s sac
 - Antişok plastik disk tampon
 - Fırın içinde kullanılmaz
 - Raylar önden ve arkadan stoperli
 - 1/1 GN 8
- Dimensions : 485x650x1000 mm
 - 25x25 mm AISI 304 s/s tubular construction
 - 1 mm AISI 304 s/s top shelf
 - Shock-proof plastic disc bumpers
 - Not for bakery usage.
 - Rails with stop bars at both sides
 - 1/1 GN 8



Z RAYLI GN KÜVET TAŞIMA ARABALARI

Z- RAILS GN CONTAINER TRANSPORT TROLLEYS

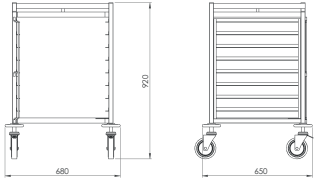

ZSCT 208

- Dış Ölçüler : 680x650x920 mm
- 25x25 mm AISI 304 s/s profil
- Üst tabla 1 mm AISI 304 s/s sac
- Antişok plastik disk tampon
- Fırın içinde kullanılmaz
- Raylar önden ve arkadan
- 2/1 GN 8

- Dimensions : 680x650x920 mm
- 25x25 mm AISI 304 s/s tubular construction
- 1 mm AISI 304 s/s top shelf
- Shock-proof plastic disc bumpers
- Not for bakery usage.
- Rails with stop bars at both sides
- 2/1 GN 8

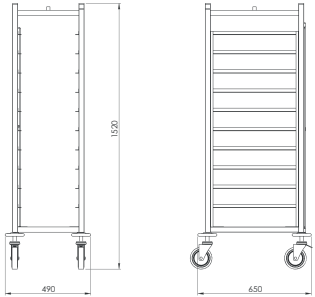

ZSCT 110

- Dış Ölçüler : 490x650x1520 mm
- 25x25 mm AISI 304 s/s profil
- Üst tabla 1 mm AISI 304 s/s sac
- Antişok plastik disk tampon
- Fırın içinde kullanılmaz
- Raylar önden ve arkadan stoperli
- 1/1 GN 10

- Dimensions : 490x650x1520 mm
- 25x25 mm AISI 304 s/s tubular construction
- 1 mm AISI 304 s/s top shelf
- Shock-proof plastic disc bumpers
- Not for bakery usage.
- Rails with stop bars at both sides
- 1/1 GN 10

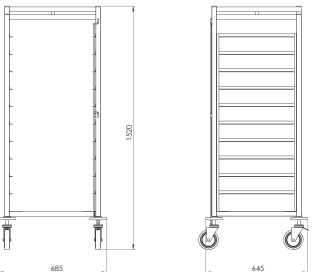

ZSCT 210

- Dış Ölçüler : 685x645x1520 mm
- 25x25 mm AISI 304 s/s profil
- Üst tabla 1 mm AISI 304 s/s sac
- Antişok plastik disk tampon
- Fırın içinde kullanılmaz
- Raylar önden ve arkadan stoperli
- 2/1 GN 10

- Dimensions : 685x645x1520 mm
- 25x25 mm AISI 304 s/s tubular construction
- 1 mm AISI 304 s/s top shelf
- Shock-proof plastic disc bumpers
- Not for bakery usage.
- Rails with stop bars at both sides
- 2/1 GN 10

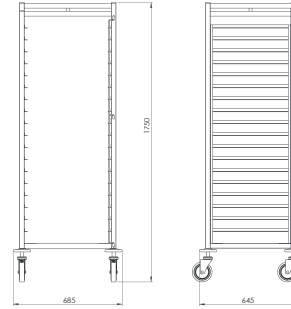

ZSCT 218

- Dış Ölçüler : 685x645x1750 mm
- 30x30 mm AISI 304 s/s profil
- Üst tabla 1 mm AISI 304 s/s sac
- Antişok plastik disk tampon
- Fırın içinde kullanılmaz
- Raylar önden ve arkadan stoperli
- 2/1 GN 18

- Dimensions : 685x645x1750 mm
- 30x30 mm AISI 304 s/s tubular construction
- 1 mm AISI 304 s/s top shelf
- Shock-proof plastic disc bumpers
- Not for bakery usage.
- Rails with stop bars at both sides
- 2/1 GN 18



SERVİS TEPSİSİ TAŞIMA ARABALARI

TRAY TRANSPORT TROLLEYS

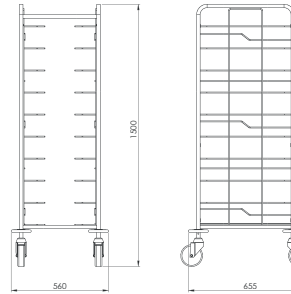

CLT 110T

- Dış Ölçüler : 560x655x1500 mm
- 25x25 mm AISI 304 s/s kare profil karkas
- Paslanmaz çelik tel raylar
- Anti-şok plastik disk tampon
- 1/1 GN-EN 10

- Dimensions : 560x655x1500 mm
- 25x25 mm AISI 304 s/s square tube frame
- Stainless steel wire rails
- Shock-proof plastic bumpers
- 1/1 GN-EN 10

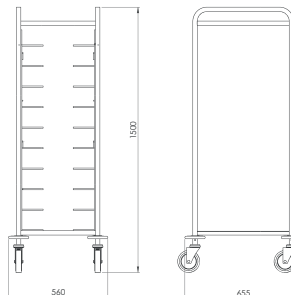

CLT 110TL2

- Dış Ölçüler : 560x655x1500 mm
- 25x25 mm AISI 304 s/s kare profil karkas
- Paslanmaz çelik tel raylar
- Anti-şok plastik disk tampon
- İki tarafı lamine panel kaplı
- 1/1 GN-EN 10

- Dimensions : 560x655x1500 mm
- 25x25 mm AISI 304 s/s square tube frame
- Stainless steel wire rails
- Shock-proof plastic bumpers
- Two sides are covered with laminated panels
- 1/1 GN-EN 10



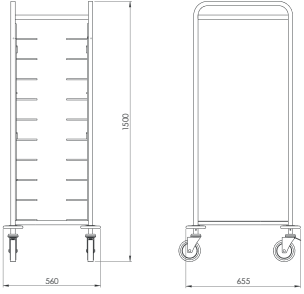

CLT 110TL3

- Dış Ölçüler : 560x655x1500 mm
 - 25x25 mm AISI 304 s/s kare profil karkas
 - Paslanmaz çelik tel raylar
 - Anti-şok plastik disk tampon
 - Üst ve üç tarafı lamine panel kaplı
 - 1/1 GN-EN 10
- Dimensions: 560x655x1500 mm
 - 25x25 mm AISI 304 s/s square tube frame
 - Stainless steel wire rails
 - Shock-proof plastic bumpers
 - Top and three sides are covered with laminated panels
 - 1/1 GN-EN 10

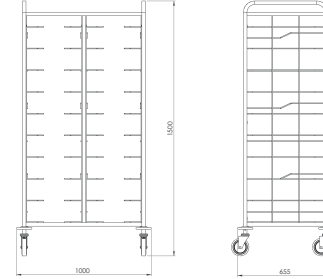

CLT 110DT

- Dış Ölçüler : 1000x655x1500 mm
 - 25x25 mm AISI 304 s/s kare profil karkas
 - Paslanmaz çelik tel raylar
 - Anti-şok plastik disk tampon
 - 1/1 GN-EN 10x2
- Dimensions: 1000x655x1500 mm
 - 25x25 mm AISI 304 s/s square tube frame
 - Stainless steel wire rails
 - Shock-proof plastic bumpers
 - 1/1 GN-EN 10x2

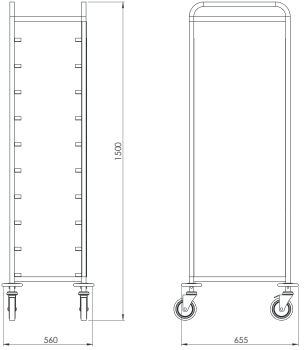

CLT 110TP2

- Dış Ölçüler : 560x655x1500 mm
 - 25x25 mm AISI 304 s/s kare profil karkas
 - Paslanmaz çelik L raylar
 - Anti-şok plastik disk tampon
 - İki tarafı lamine panel kaplı
 - 1/1 GN-EN 10
- Dimensions: 560x655x1500 mm
 - 25x25 mm AISI 304 s/s square tube frame
 - Stainless steel L rails
 - Shock-proof plastic bumpers
 - Two sides are covered with laminated panels
 - 1/1 GN-EN 10

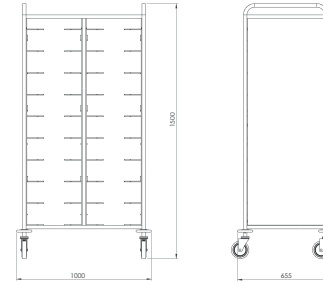

CLT 110DTL2

- Dış Ölçüler : 1000x655x1500 mm
 - 25x25 mm AISI 304 s/s kare profil karkas
 - Paslanmaz çelik tel raylar
 - Anti-şok plastik disk tampon
 - İki tarafı lamine panel kaplı
 - 1/1 GN-EN 10x2
- Dimensions: 1000x655x1500 mm
 - 25x25 mm AISI 304 s/s square tube frame
 - Stainless steel wire rails
 - Shock-proof plastic bumpers
 - Two sides are covered with laminated panels
 - 1/1 GN-EN 10x2

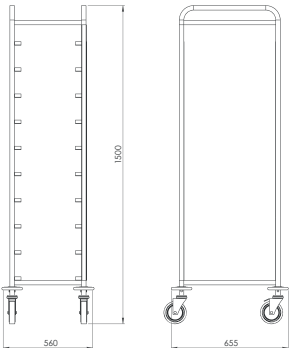

CLT 110TP3

- Dış Ölçüler : 560x655x1500 mm
 - 25x25 mm AISI 304 s/s kare profil karkas
 - Paslanmaz çelik L raylar
 - Anti-şok plastik disk tampon
 - Üst ve üç tarafı lamine panel kaplı
 - 1/1 GN-EN 10
- Dimensions : 560x655x1500 mm
 - 25x25 mm AISI 304 s/s square tube frame
 - Stainless steel L rails
 - Shock-proof plastic bumpers
 - Top and three sides are covered with laminated panels
 - 1/1 GN-EN 10

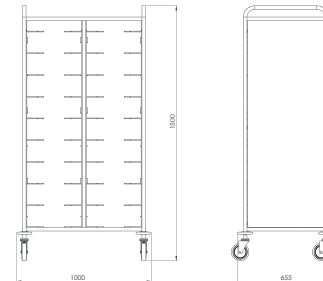

CLT 110DTL3

- Dış Ölçüler : 1000x655x1500 mm
 - 25x25 mm AISI 304 s/s kare profil karkas
 - Paslanmaz çelik tel raylar
 - Anti-şok plastik disk tampon
 - Üst ve üç tarafı lamine panel kaplı
 - 1/1 GN-EN 10x2
- Dimensions: 1000x655x1500 mm
 - 25x25 mm AISI 304 s/s square tube frame
 - Stainless steel wire rails
 - Shock-proof plastic bumpers
 - Top and three sides are covered with laminated panels
 - 1/1 GN-EN 10x2



SERVİS TEPSESİ TAŞIMA ARABALARI TRAY TRANSPORT TROLLEYS

SERVİS TEPSİSİ TAŞIMA ARABALARI

TRAY TRANSPORT TROLLEYS

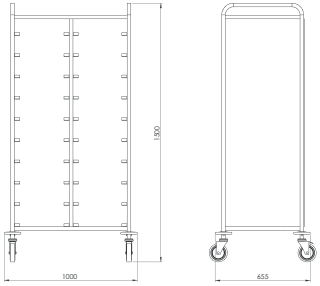

CLT 110DTP2

- Dış Ölçüler : 1000x655x1500 mm
- 25x25 mm AISI 304 s/s kare profil karkas
- Paslanmaz çelik L raylar
- Anti-şok plastik disk tampon
- İki tarafı lamine panel kaplı
- 1/1 GN-EN 10x2
- Dimensions: 1000x655x1500 mm
- 25x25 mm AISI 304 s/s square tube frame
- Stainless steel L rails
- Shock-proof plastic bumpers
- Two sides are covered with laminated panels
- 1/1 GN-EN 10x2

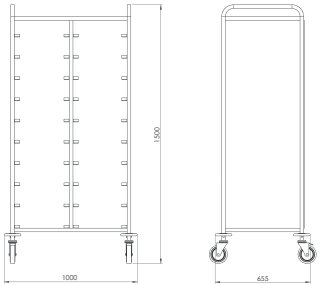

CLT 110DTP3

- Dış Ölçüler : 1000x655x1500 mm
- 25x25 mm AISI 304 s/s kare profil karkas
- Paslanmaz çelik L raylar
- Anti-şok plastik disk tampon
- Üst ve üç tarafı lamine panel kaplı
- 1/1 GN-EN 10x2
- Dimensions : 1000x655x1500 mm
- 25x25 mm AISI 304 s/s square tube frame
- Stainless steel L rails
- Shock-proof plastic bumpers
- Top and three sides are covered with laminated panels
- 1/1 GN-EN 10x2



PATİSERİ ARABALARI

PATISSERIE TROLLEYS

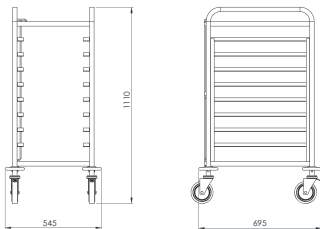

PLCT 0864

- Dış Ölçüler : 545x695x1110 mm
- 20x20 AISI 304 s/s kare profil
- Güvenlik için tepsi rayları önden ve arkadan kaymaya karşı set korumalıdır.
- Raylar kaynaklıdır.
- Anti-şok plastik disk tampon
- 2 si frenli Ø 125 mm 4 döner tekerlek
- Dimensions : 545x695x1110 mm
- 20x20 AISI 304 s/s square tubes
- "U" rails with stop bars at both sides
- Welded rails
- Shock-proof plastic bumpers
- 4 rotating wheels Ø 125 mm, 2 with brakes

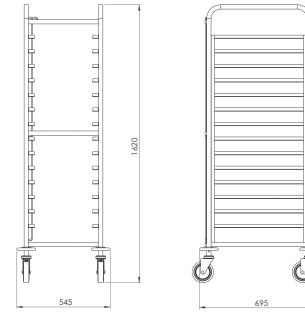

PLCT 1464

- Dış Ölçüler : 545x695x1620 mm
- 20x20 AISI 304 s/s kare profil
- Güvenlik için tepsi rayları önden kaymaya karşı set korumalı, arka yüzden ise boydan boya kilitlenebilir
- AISI 304 s/s mil korumalıdır.
- Raylar kaynaklıdır.
- Anti-şok plastik disk tampon
- 2 si frenli Ø 125 mm 4 döner tekerlek

- Dış Ölçüler : 545x695x1620 mm
- 20x20 AISI 304 s/s square tube
- "U" rails with stop bars at both sides
- Completely lockable AISI 304 s/s protective rod at back
- Welded rails
- Shock-proof plastic bumpers
- 4 rotating wheels Ø 125 mm, 2 with brakes



PATİSERİ ARABALARI

PATISSERIE TROLLEYS

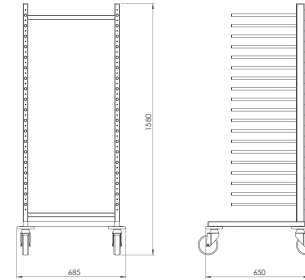

PLCT 2064

- Dış Ölçüler : 685x650x1580 mm
- Taşıyıcı konstrüksiyon 30x50 mm / 30x30 mm AISI 304 s/s kutu profil
- Tepsi taşıma boruları Ø13 mm AISI 304 s/s boru
- 2 si frenli Ø 125 mm 4 döner tekerlek
- Dimensions : 685x650x1580 mm
- Frame 30x50 mm / 30x30 mm AISI 304 s/s square tube
- Dish holding tubular bars Ø13 mm AISI 304 s/s
- 4 rotating wheels Ø 125 mm, 2 with brakes

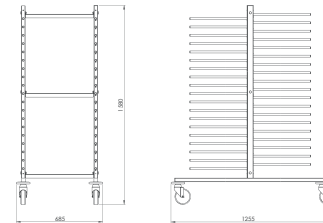

PLCT 2064D

- Dış Ölçüler : 685x1255x1580 mm
- Taşıyıcı konstrüksiyon 30x50 mm / 30x30 mm AISI 304 s/s boru
- Tepsi taşıma boruları Ø13 mm AISI 304 s/s boru
- 2 si frenli Ø 125 mm 4 döner tekerlek

- Dimensions : 685x1255x1580 mm
- Frame 30x50 mm / 30x30 mm AISI 304 s/s square tubes.
- Dish holding tubular bars Ø13 mm AISI 304 s/s
- 4 rotating wheels Ø 125 mm, 2 with brakes



ORDÖVR ARABALARI

HORS D'OEUVRE TROLLEYS



OIA 711

- Dış ölçüler : 340x470x890 mm
- Karkas malzemesi paslanmaz çelik
- Tabak taşıyıcı çubuklar kaydırmaz termoplastik elastomer malzemeden üretilir
- Ø 16 - 32 cm tabaklar için ayarlanabilir
- Kapasite 20 tabak

- Dimensions : 340x470x890 mm
- Stainless steel frame
- The plate storage bars are made of non-slippery thermoplastic elastomer material
- Adjustable to accommodate plates between Ø 16 - 32 cm (hors d'oeuvre trolley)
- Capacity 20 plates

OIA 811

- Dış ölçüler : 720x720x1820 mm
- Karkas malzemesi paslanmaz çelik
- Tabak taşıyıcı çubuklar kaydırmaz termoplastik elastomer malzemeden üretilir
- Tabak taşıyıcı çubuklar max. 1,25 kg yük taşır
- Ø 16 - 32 cm tabaklara göre ayarlanabilir
- Demonte olmasından dolayı nakliye avantajı sağlamaktadır
- 125 mm çapında dört adet frenli tekerlek mevcuttur
- Kapasite 80 tabak

- Dimensions : 720x720x1820 mm
- Stainless steel frame
- The plate storage bars are made of non-slippery thermoplastic elastomer material
- The plate storage bars carry max. 1,25 kg weight
- Adjustable to accommodate plates between Ø 16 - 32 cm (hors d'oeuvre trolley)
- Saves on shipping costs due to its dismantling feature
- There are 4 pcs of Ø 125 mm casters with break
- Capacity 80 plates

PASLANMAZ ÇELİK SERVİS ARABALARI

STAINLESS STEEL SERVICE TROLLEYS

CSA 221

- Dış Ölçüler : 910x615x925 mm
- Kapasite : 80 kg
- Ağırlık : 13 kg
- AISI 304 paslanmaz çelikten üretilmiştir.
- Pres baskılı tablalar temizlikte kolaylık sağlar.
- 2 adet frenli, 2 adet sabit tam döner tekerleklidir
- Sert zeminlerde kullanılan arabalarda ses çıkmasını önlemek için poliüretan ya da kauçuk tekerlekler kullanılır

- Dimensions : 910x615x925 mm
- Capacity : 80 kg
- Weight : 13 kg
- Complete AISI 304 s/s
- Pressed shelves are easy to clean
- 4 rotating wheels, 2 with brakes
- Polyurethane or rubber wheels to be used on hard grounds to prevent the noise

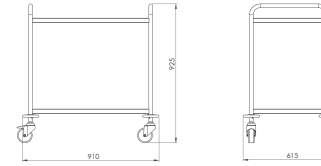

CSA 321

- Dış Ölçüler : 910x615x925 mm
- Kapasite : 120 kg
- Ağırlık : 16 kg
- AISI 304 paslanmaz çelikten üretilmiştir
- Pres baskılı tablalar temizlikte kolaylık sağlar.
- 2 adet frenli, 2 adet sabit tam döner tekerleklidir
- Sert zeminlerde kullanılan arabalarda ses çıkmasını önlemek için poliüretan ya da kauçuk tekerlekler kullanılır

- Dimensions : 910x615x925 mm
- Capacity : 120 kg
- Weight : 16 kg
- Complete AISI 304 s/s
- Pressed shelves are easy to clean
- 4 rotating wheels, 2 with brakes
- Polyurethane or rubber wheels to be used on hard grounds to prevent the noise

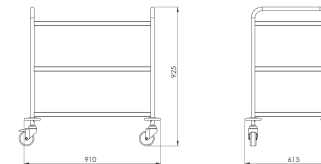

PASLANMAZ ÇELİK SERVİS ARABALARI

STAINLESS STEEL SERVICE TROLLEYS

CSA 421

- Dış Ölçüler : 910x615x1290 mm
- Kapasite : 150 kg
- Ağırlık : 25 kg
- AISI 304 paslanmaz çelikten üretilmiştir
- Pres baskılı tablalar temizlikte kolaylık sağlar.
- 2 adet frenli, 2 adet sabit tam döner tekerleklidir
- Sert zeminlerde kullanılan arabalarda ses çıkmasını önlemek için poliüretan ya da kauçuk tekerlekler kullanılır
- Dimensions : 910x615x1290 mm
- Capacity : 150 kg
- Weight : 25 kg
- Complete AISI 304 s/s
- Pressed shelves are easy to clean
- 4 rotating wheels, 2 with brakes
- Polyurethane or rubber wheels to be used on hard grounds to prevent the noise

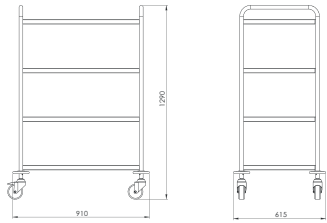

PBT 211

- Dış Ölçüler : 1275x675x1100 mm
- Karkas AISI 304 s/s profilden üzeri komple laminant kaplı
- Üst havuz AISI 304 s/s sacdan, içinde 1 adet kauçuk çöp kutusu
- 3x1/6 GNX15 cm çatal-kaşık-bıçak kabı
- 1 x 550x550x250 mm tabak havuzu
- 3 x 500x500 mm basket rayı
- 2 x sürgü kapak, 1 x plastik çöp bidonu
- 2 si sabit 2 si frenli, dönerli Ø 125 mm tekerlek
- Dimensions : 1275x675x1100 mm
- Metal structure is made of AISI 304 stainless steel profile coated with laminate completely
- Top well is made of AISI 304 s/s with a rubber trash bin
- 3 x 1/6 GNX15 cm cutlery unit
- 1 x 550x550x250 mm well for plates
- 3 x basket rails 500x500
- 2 x sliding door and 1x plastic trash bin
- 2 of the Ø 125 mm wheels are fixed with break the others are rotating

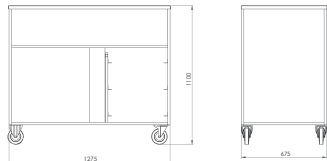

TABAK TAŞIMA ARABALARI

DISH STORAGE TROLLEYS

TBA 411

- Dış ölçüler : 730x730x815 mm
- Polietilen malzemeden üretilir
- Ayarlanabilir 4 bölmedir
- 18-33 cm Ø tabaklara ayarlanabilir.
- Tabak çapına göre 150 ile 300 arası tabak kapasitelidir
- Dimensions : 730x730x815 mm
- Produced in polyethylene
- 4 adjustable compartments
- Adjustable to accommodate plates between Ø 18 -33 cm
- Capacity to store 150 to 300 plates based on plate size



TBA 611

- Dış ölçüler : 1100x710x800 mm
- Polietilen malzemeden üretilir
- Ayarlanabilir 6 bölmedir
- 32,5 cm Ø kadar olan tabaklara ayarlanabilir
- Tabak çapına göre 250 ile 450 adet tabak kapasitelidir
- Siyah ve kahverengi renk opsiyonu mevcuttur
- Dimensions : 1100x710x800 mm
- Produced in polyethylene
- 6 adjustable compartments
- Adjustable to accommodate plates with Ø 32.5 cm
- Capacity to store 250 to 450 plates based on plate size
- There are black and brown color options



BASKET TAŞIMA ARABALARI

BASKET TRANSPORT TROLLEYS

KTA 111

- Dış Ölçüler : 580x580x208 mm
- AISI 304 s/s 1,2mm alt tabla
- Plastik göbekli, yağa dayanıklı kauçuk sırtlı tekerlek
- Dimensions: 580x580x208 mm
- AISI 304 s/s 1.2 mm thickness for lower shelf
- Grease proof rubber wheels

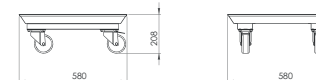

BASKET TAŞIMA ARABALARI

BASKET TRANSPORT TROLLEYS

KTA 121

- Dış Ölçüler : 740x580x830 mm
- AISI 304 s/s 1,2mm alt tabla
- Ø21 mm AISI 304 s/s itme kulbu
- Plastik göbekli, yağa dayanıklı kauçuk sırtlı tekerlek

- Dimensions : 740x580x830 mm
- Complete AISI 304 s/s with lower shelf
- Ø21 mm handle for pushing
- Grease proof rubber wheels .

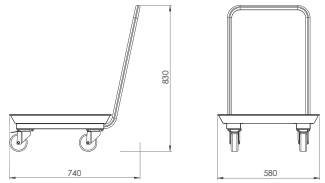

BTR 606

- Dış Ölçüler : 640x590x1820 mm
- 25X25 mm AISI 304 s/s kutu profil konstrüksiyon
- L raylı 1,5 mm AISI 304 s/s
- Anti-şok plastik disk tampon
- Plastik göbekli, yağa dayanıklı kauçuk sırtlı tekerlek

- Dimensions : 640x590x1820 mm
- 25X25 mm AISI 304 s/s square tube rack frame
- 1,5 mm AISI 304 s/s L shaped rails
- Shock-resistant plastic bumpers
- Grease proof rubber wheels .

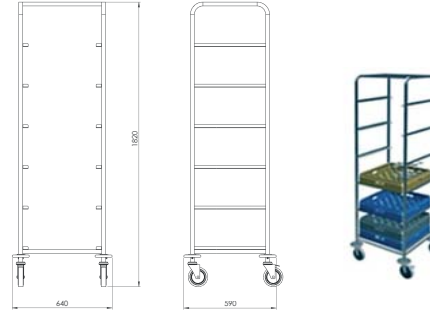

BTR 303

- Dış Ölçüler : 640x590x1110 mm
- 25X25 mm AISI 304 s/s kutu profil konstrüksiyon
- L raylı 1,5 mm AISI 304 s/s
- Anti-şok plastik disk tampon
- Plastik göbekli, yağa dayanıklı kauçuk sırtlı tekerlek

- Dimensions : 640x590x1110 mm
- 25X25 mm AISI 304 s/s square tube frame rack
- 1,5 mm AISI 304 s/s L shaped rails
- Shock-resistant plastic bumpers
- Grease proof rubber wheels .

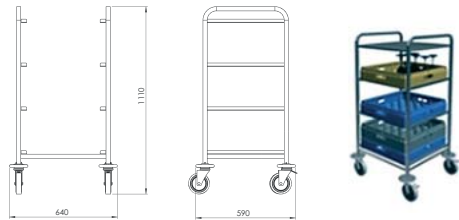

BTR 612

- Dış Ölçüler : 1170x590x1820 mm
- 25X25 mm AISI 304 s/s kutu profil konstrüksiyon
- L raylı 1,5 mm AISI 304 s/s
- Anti-şok plastik disk tampon
- Plastik göbekli, yağa dayanıklı kauçuk sırtlı tekerlek

- Dimensions : 1170x590x1820 mm
- 25X25 mm AISI 304 s/s square tube frame rack
- 1,5 mm AISI 304 s/s L shaped rails
- Shock-resistant plastic disc bumpers
- Grease proof rubber wheels .

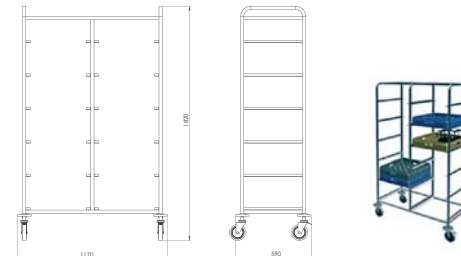

GARSON BANKOLARI WAITER STATIONS

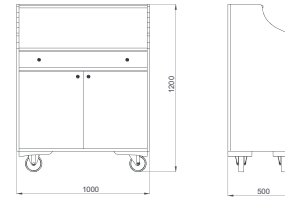

GBN 512

- Ölçüler : 1000x500x1200 mm
- 2 adet kapak bulunur
- 1 adet çekmece bulunur
- MDF üzeri ahşap kaplama
- Ağırlık : 53 kg

- Dimensions: 1000x500x1200 mm
- 2 pcs doors
- 1 pcs drawer
- Wooden veneer on MDF
- Solid wooden
- Weight: 53 kg

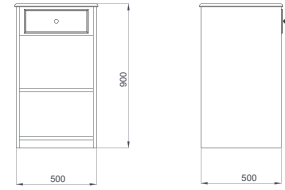

GBN 6002

- Ölçüler : 500x500x900 mm
- 1 adet çekmece bulunur
- MDF üzeri ahşap kaplama
- Ağırlık : 28 kg

- Dimensions: 500x500x900 mm
- 1 pcs drawer
- Wooden veneer on MDF
- Weight: 28 kg



GARSON BANKOLARI WAITER STATIONS

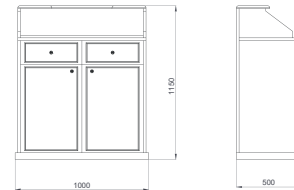

GBN 7212

- Ölçüler : 1000x500x1150 mm
- 2 adet kapak bulunur
- 2 adet çekmece bulunur
- MDF üzeri ahşap kaplama
- Ağırlık : 69 kg

- Dimensions: 1000x500x1150 mm
- 2 pcs doors
- 2 pcs drawers
- Wooden veneer on MDF
- Weight: 69 kg



GBN 7222

- Ölçüler : 1000x500x1400 mm
- 2 adet kapak bulunur
- 2 adet çekmece bulunur
- MDF üzeri ahşap kaplama
- Ağırlık : 74 kg

- Dimensions: 1000x500x1400 mm
- 2 pcs doors
- 2 pcs drawers
- Wooden veneer on MDF
- Weight: 74 kg



CARVING ÜNİTELERİ

CARVING UNITS

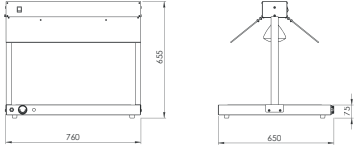

CRV 380

- Dış ölçüler: 800x550x655 mm
- 2500 watt
- Çift Haloterm Lambalı / Paslanmaz YüzeY Isıtmalı
- Dimensions: 800x550x655 mm
- 2500 watt
- Double Haloterm Lamp / stainless steel surface heating

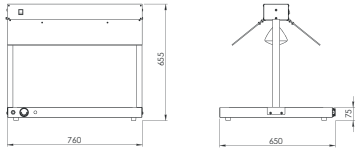

CRV 390

- Dış ölçüler: 800x550x655 mm
- 2500 watt
- Çift Haloterm Lambalı / Cam YüzeY Isıtmalı
- Dimensions: 800x550x655 mm
- 2500 watt
- Double Haloterm Lamp / glass surface heating

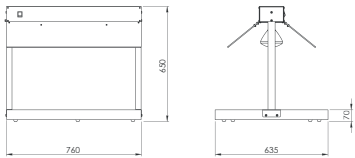

CRV 400

- Dış ölçüler: 800x550x655 mm
- 500 watt
- Çift Haloterm Lambalı / Masif YüzeY
- Dimensions: 800x550x655 mm
- 500 watt
- Double Haloterm Lamp / wooden surface



CRV 410

- Dış ölçüler: Ø400x665 mm
- 2250 watt
- Tek Haloterm Lambalı / Paslanmaz YüzeY Isıtmalı
- Dimensions: Ø400x665 mm
- 2250 watt
- Single Haloterm Lamp / stainless steel surface heating

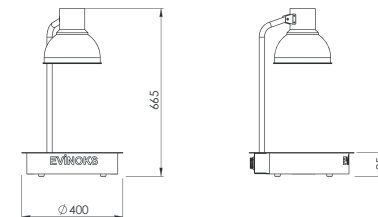

ASKILI SICAK TUTUCU LAMBALAR HEAT LAMPS WITH ADJUSTABLE CABLE

Askılı sıcak tutucu lambaları restoran ve otel mutfaklarının hem BOH (Back of the house) hem de FOH (Front of the house) bölümlerinde kullanılmak için tasarlandı. Her bir ünitedeki 250 Watt gücündeki enfraraj lambalar geri sarmalı helizon kablodur. Kablo boyu 1300 mm'e kadar uzayabilir. Enfraraj lambalar kırmızı veya beyaz ışıklı olabilir. Elektrik bağlantısı: 230 Volt / 1Ph. / 50Hz; 250 Watt.

Hanging Heat Lamps were designed to be used at both front and back of house sections of restaurants and hotel kitchens. Each of the 250 Watt infrared lamps come with retractable spiral cable and length of the cable can be extended up to 1300 mm. Infrared lamps can be either with red or white light. Electrical values are 230 Volt / Single Ph. / 50Hz; 250 Watt

ASSOS SERİSİ / ASSOS SERIES



- Başlık ölçüsü : Ø245x260 mm
- Yüksek ayarlı kablo (550 - 1300 mm)
- Açma- Kapama anahtarı mevcuttur
- Head dimensions : Ø245x260 mm
- Adjustable helix cable (550 - 1300 mm)
- On - Off Switch .

GÖBEKLİTEPE SERİSİ / GÖBEKLİTEPE SERIES



- Başlık ölçüsü : Ø270x320 mm
- Yüksek ayarlı kablo (550 - 1300 mm)
- Açma- Kapama anahtarı mevcuttur
- Head dimensions : Ø270x320 mm
- Adjustable helix cable (550 - 1300 mm)
- On - Off Switch .

ZEUGMA SERİSİ / ZEUGMA SERIES



- Başlık ölçüsü : Ø310x265 mm
- Yüksek ayarlı kablo (550 - 1300 mm)
- Açma- Kapama anahtarı mevcuttur
- Head dimensions : Ø310x265 mm
- Adjustable helix cable (550 - 1300 mm)
- On - Off Switch .

ASKI APARATLARI / HANGING BRACKETS

Tavanın yüksek olması ve yan yana birden fazla ısıtıcı lamba kullanılması durumunda askı aparatı monte edilebilir. Askı aparatı lambaların 1000 mm daha aşağıya inmesini sağlar. Ray yüksekliği bağlantı boruları üzerinde bulunan deliklerden ayarlanabilir.

A hanging bracket can be assembled if the ceiling is too high or more than one heating lamps are to be used side by side. The hanging bracket enables the lamps to go down by 1000 mm. The height of the rail can be adjusted by using the holes located on the connection tubes.

3 LAMBALI ASKI APARATI / 3 LAMP HANGER BRACKET



- L : 1100 mm (3 Lamba)
- Yüksekliği ayarlanabilir (500 -1000 mm)
- L : 1100 mm (3 Lamps)
- Adjustable height (500 -1000 mm)

4 LAMBALI ASKI APARATI / 4 LAMP HANGER BRACKET



- L : 1400 mm (4 Lamba)
- Yüksekliği ayarlanabilir (500 -1000 mm)
- L : 1400 mm (4 Lamps)
- Adjustable height (500 -1000 mm)

MOBİL BAR VE RESEPSİYON MASASI

MOBİL BAR MOBILE BAR

- Dış Ölçüler : 1500x600x1150 mm
- Kullanıcı tarafı paslanmaz çelik, gövde malzemesi MDF LAM ve karkas malzemesi DKP+ESB veya paslanmaz çelik, üst tabla kompozit taş ya da mermer olarak üretilebilir.
- Dimensions : 1500x600x1150 mm
- Operator side is stainless steel, body is MDF LAM and frame is EPC steel or s/s and top can be composite stone or marble.

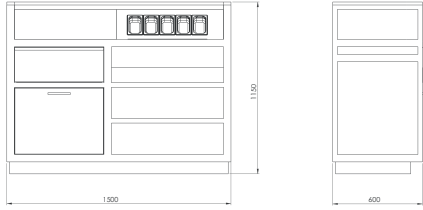

MOBILE BAR AND RECEPTION DESK

MOBİL RESEPSİYON MASASI MOBILE RECEPTION DESK

- Dış Ölçüler : 1500x600x1150 mm
- Gövde malzemesi MDF LAM, karkas malzemesi DKP+ESB veya paslanmaz çelik
- Dimensions : 1500x600x1150 mm
- Body is MDF LAM and frame is EPC steel or s/s and top can be composite stone or marble.

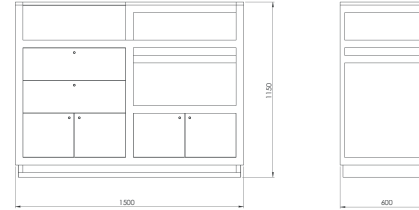





FABRİKA / FACTORY

Demirtaş Organize Sanayi Bölgesi
Mimoza Sokak No: 5 16245
Bursa / TÜRKİYE
T. +90 224 262 14 00 (Pbx)
F. +90 224 262 14 14 - 15

MARMARA BÖLGE MÜDÜRLÜĞÜ

Gsm. +90 532 507 28 11

ANADOLU BÖLGE MÜDÜRLÜĞÜ

Gsm. +90 549 549 33 43

AKDENİZ BÖLGE MÜDÜRLÜĞÜ

Gsm. +90 533 469 13 25

EGE BÖLGE MÜDÜRLÜĞÜ

Gsm. +90 549 661 12 34

www.evinoks.com.tr

GRAFİK TASARIM
Başka Tanıtım

BASIM YERİ
A4 Ofset Matbaacılık San.ve Tic.Ltd.Şti.

BASIM TARİHİ
30/01/2018



www.kosgeb.gov.tr